

EXISTING

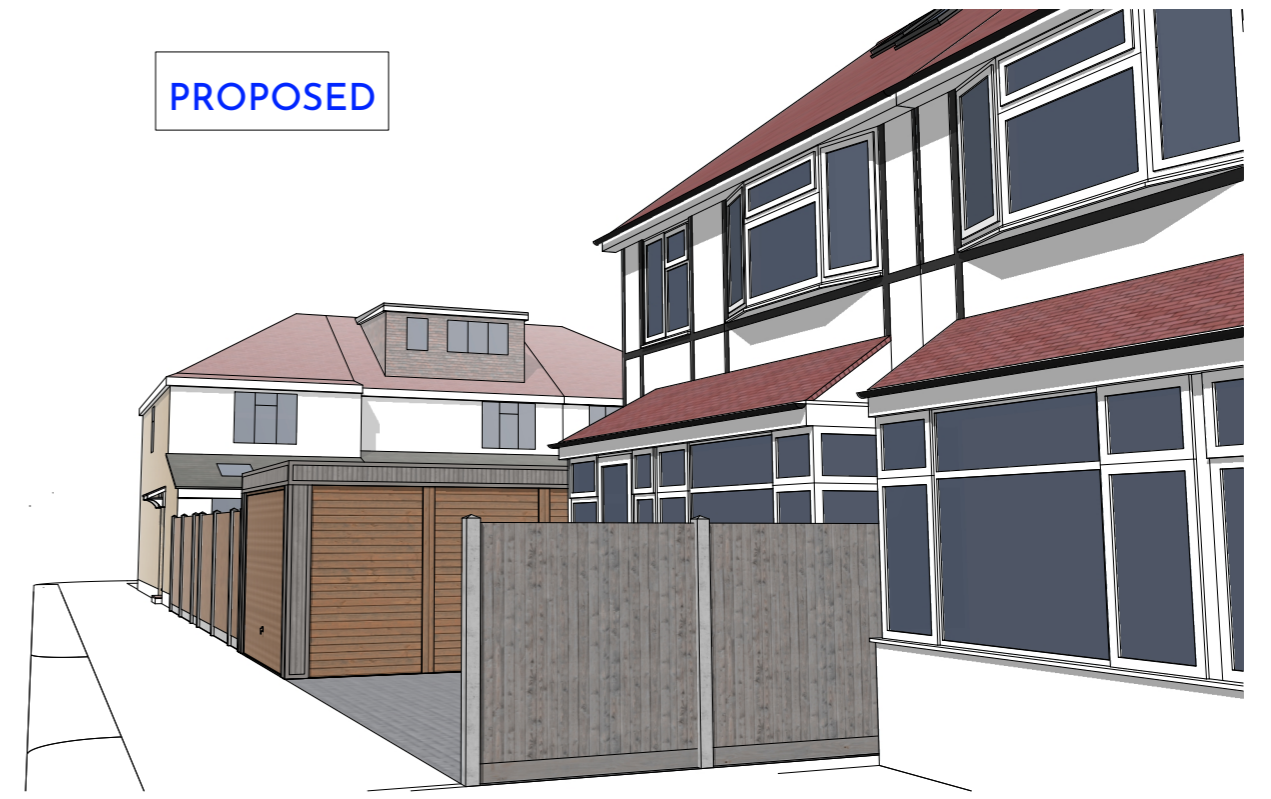

STREET VIEW LOOKING SOUTH

PROPOSED



STREET VIEW LOOKING SOUTH

EXISTING

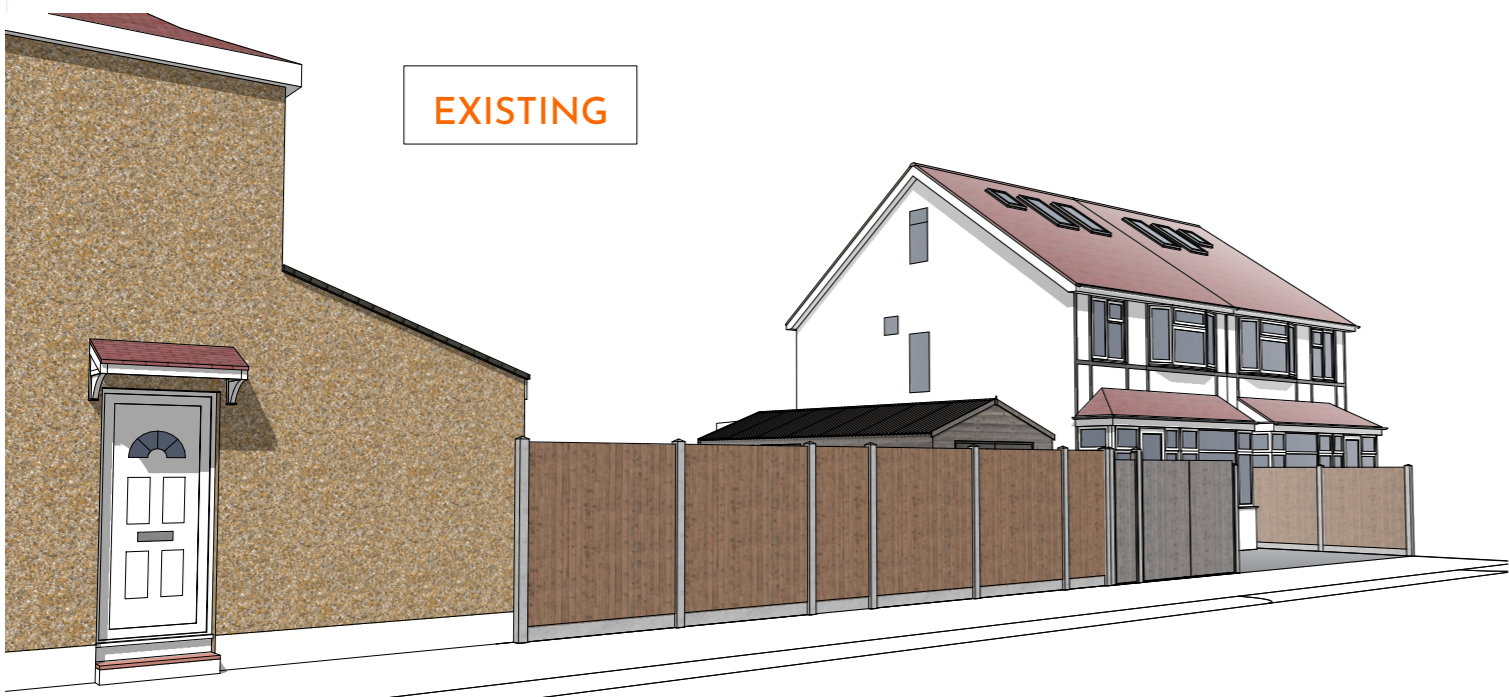

STREET VIEW LOOKING NORTH

PROPOSED

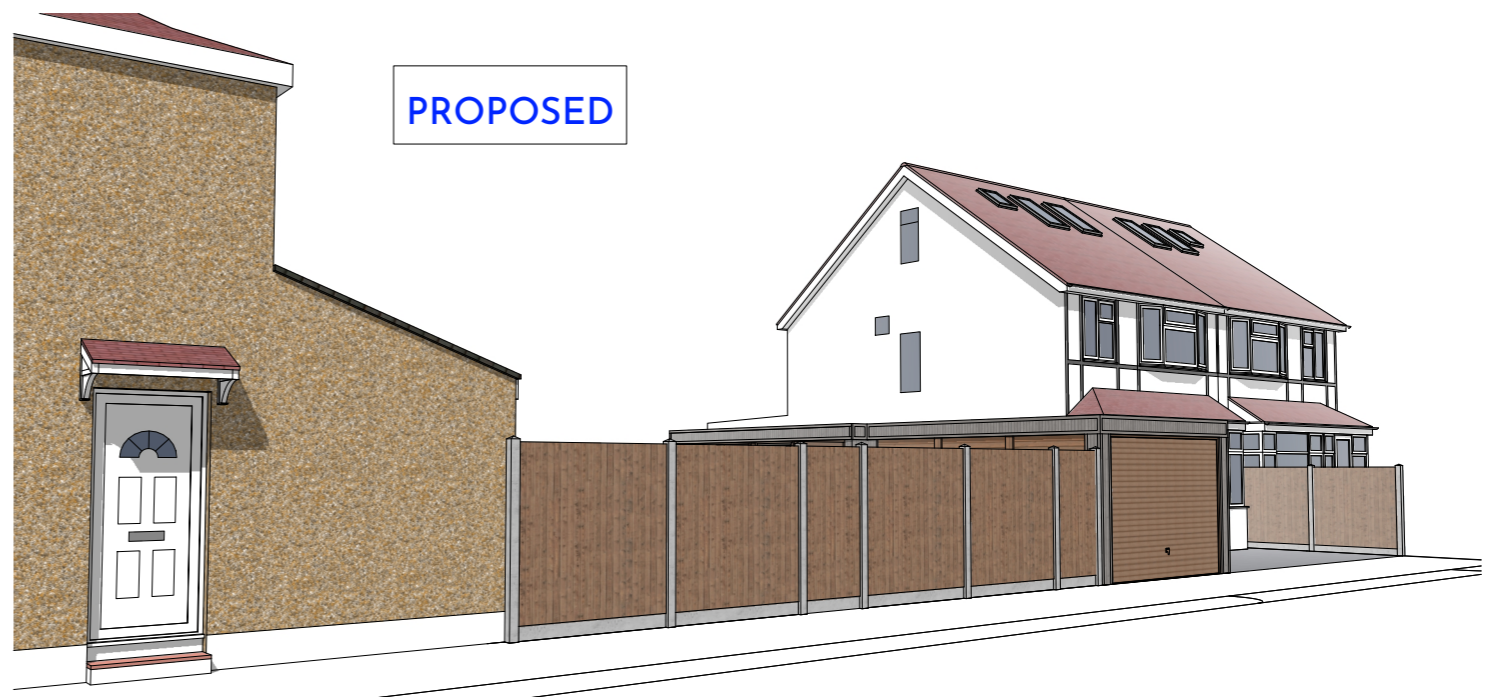

STREET VIEW LOOKING NORTH

PROJECT
20 CHUDLEIGH ROAD
TWICKENHAM
TW2 7QR

TITLE
PERSPECTIVE VIEWS I

STATUS
PLANNING

SCALE DATE DRAWN
NTS 06.12.24 KR

JOB/DRG NO REV
241102/P12 -



KOSMA RYBAK LTD. 124 CITY ROAD EC1V 2NX LONDON
WWW.KOSMARYBAK.COM M@KOSMARYBAK.COM T:07719700256

THIS DRAWING IS © COPYRIGHT OF KOSMA RYBAK LTD
THIS DRAWING MAY BE SCALED OR CROSS REFERENCED TO THE SCALE BAR FOR PLANNING
APPLICATION PURPOSES ONLY. DO NOT SCALE FOR ANY OTHER PURPOSE. USE FIGURED
DIMENSIONS ONLY. SUBJECT TO SITE SURVEY AND ALL NECESSARY CONSENTS. ALL
DIMENSIONS TO BE CHECKED BY USER AND ANY DISCREPANCIES, ERRORS OR OMISSIONS TO
BE REPORTED TO THE ARCHITECT BEFORE WORK COMMENCES. THIS DRAWING IS TO BE READ
IN CONJUNCTION WITH ALL OTHER RELEVANT MATERIALS.