

EXISTING

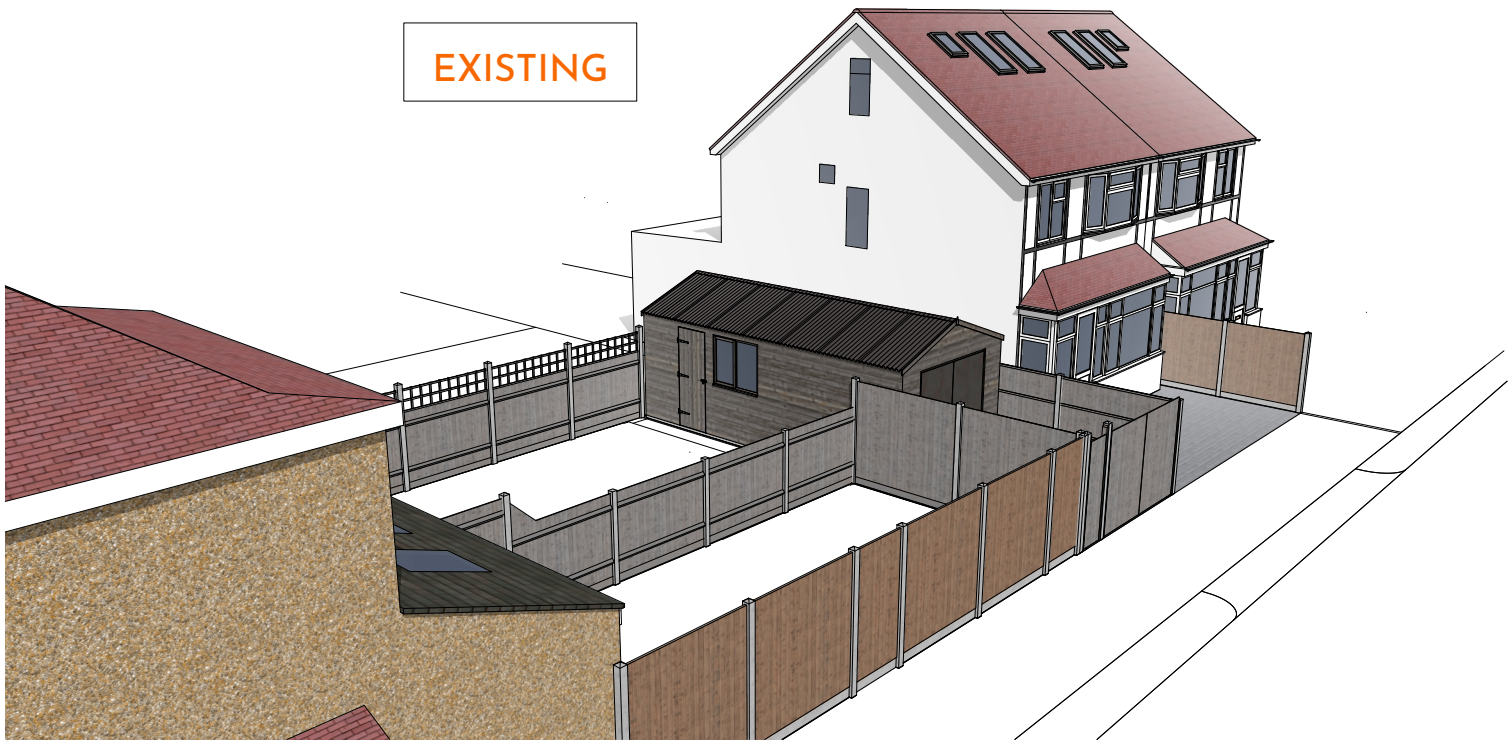

PROPOSED

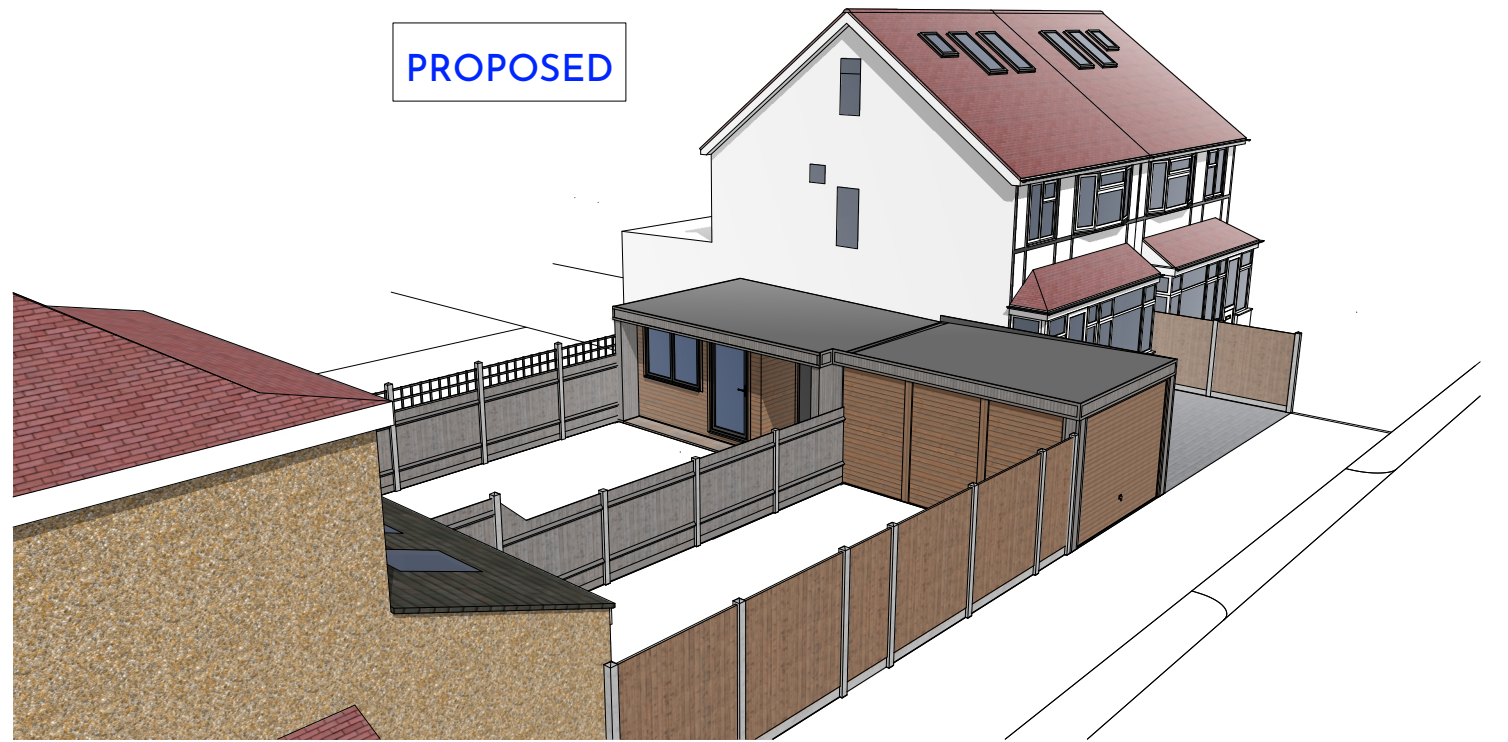

STREET BIRD'S EYE VIEW LOOKING SOUTH

EXISTING



PROPOSED

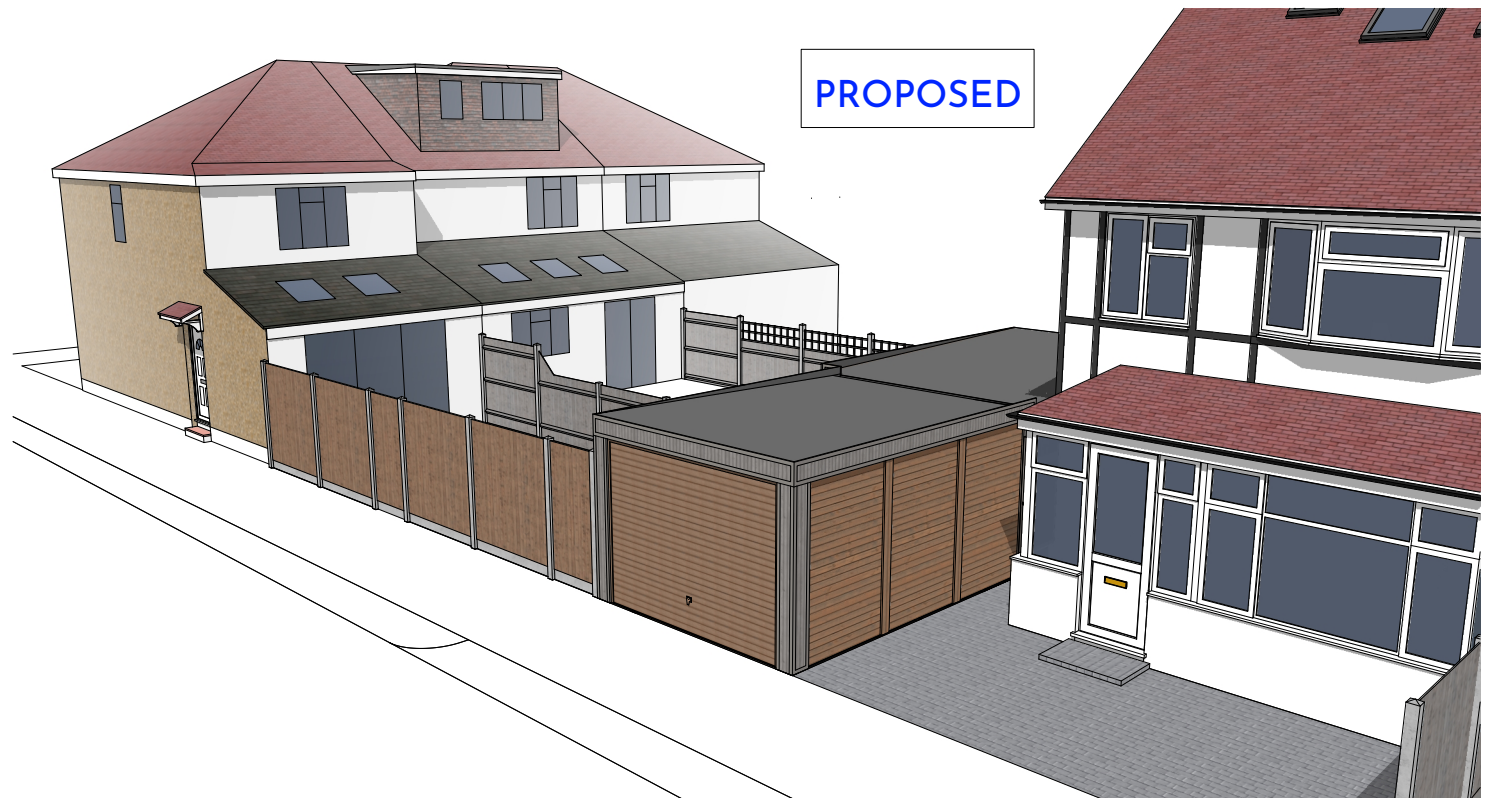

STREET BIRD'S EYE VIEW LOOKING NORTH

PROJECT  
20 CHUDLEIGH ROAD  
TWICKENHAM  
TW2 7QR

TITLE  
PERSPECTIVE VIEWS 2

STATUS  
PLANNING

SCALE DATE DRAWN  
NTS 06.12.24 KR

JOB/DRG NO REV  
241102/P13 -



KOSMA RYBAK LTD. 124 CITY ROAD EC1V 2NX LONDON  
WWW.KOSMARYBAK.COM M@KOSMARYBAK.COM T:07719700256

THIS DRAWING IS © COPYRIGHT OF KOSMA RYBAK LTD  
THIS DRAWING MAY BE SCALED OR CROSS REFERENCED TO THE SCALE BAR FOR PLANNING  
APPLICATION PURPOSES ONLY. DO NOT SCALE FOR ANY OTHER PURPOSE. USE FIGURED  
DIMENSIONS ONLY. SUBJECT TO SITE SURVEY AND ALL NECESSARY CONSENTS. ALL  
DIMENSIONS TO BE CHECKED BY USER AND ANY DISCREPANCIES, ERRORS OR OMISSIONS TO  
BE REPORTED TO THE ARCHITECT BEFORE WORK COMMENCES. THIS DRAWING IS TO BE READ  
IN CONJUNCTION WITH ALL OTHER RELEVANT MATERIALS.