

Photo Location

1 GF Proposed UFH Scale 1 : 100



1 - Photo - Showing engineered flooring sample location in Kitchen



2 - Photo Close Up - Showing engineered flooring (no original flooring remains in the property). We assume existing joists are original and will be retained.

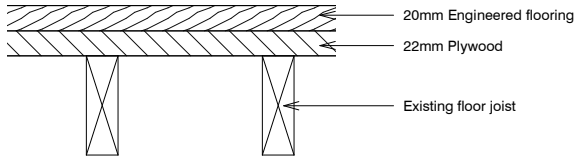

2 Existing Floor Build Up Scale 1 : 10

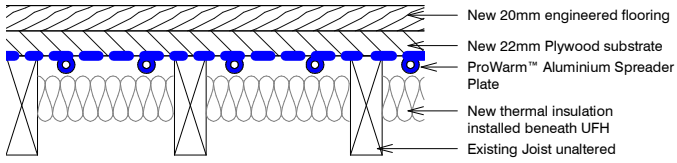

3 Proposed Floor Build Up Scale 1 : 10

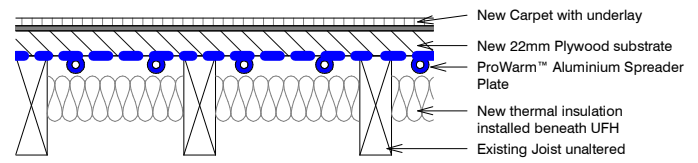

4 Proposed Floor Build Up (Carpet) Scale 1 : 10

NOTES:

- DO NOT SCALE FROM THIS DRAWING
- ALL DIMENSIONS TO BE CHECKED ON SITE PRIOR TO FABRICATION
- THIS DRAWING SHOULD BE READ IN CONJUNCTION WITH STRUCTURAL ENGINEERS DRAWINGS
- THIS DRAWING SHOULD BE READ IN CONJUNCTION WITH SERVICE ENGINEERS DRAWINGS
- COPYRIGHT OF THIS DRAWING REMAINS WITH JOHN RICH ARCHITECTS
- ANY DISCREPANCY FOUND BETWEEN THIS DRAWING AND ANY OTHER DOCUMENTS MUST BE REPORTED IMMEDIATELY BY THE CONTRACTOR
- ALL PROPRIETARY MATERIALS TO BE INSTALLED IN ACCORDANCE WITH MANUFACTURERS INSTRUCTIONS
- ALL TIMBERS TO BE PRESSURE IMPREGNATED

REVISIONS	

PROJECT
1 Old Palace Terrace, Richmond, TW9 1NB

CLIENT
Mr A Batten & Ms G Wood

A3 SCALE
SCALE BAR
As indicated

PROJECT DESCRIPTION
External and Internal Remodelling to a Listed Building

STATUS
PLANNING

DRAWING NAME
Underfloor/replacement floor detail

John Rich Architects
66 Royal Parade | Kew
Richmond | Surrey | TW9 3QD
t: 020 8940 0416 | f: 020 8940 3303
e: mail@johnricharchitects.com
w: www.johnricharchitects.com

DATE JUL 22
DRAWN: Author
CHECKED: Checker

JOB NO: 21.5980

DRAW NO: REV
A918

© Copyright John Rich Architects Ltd