

**Tree Categories.**

● A
● B
● C
● U

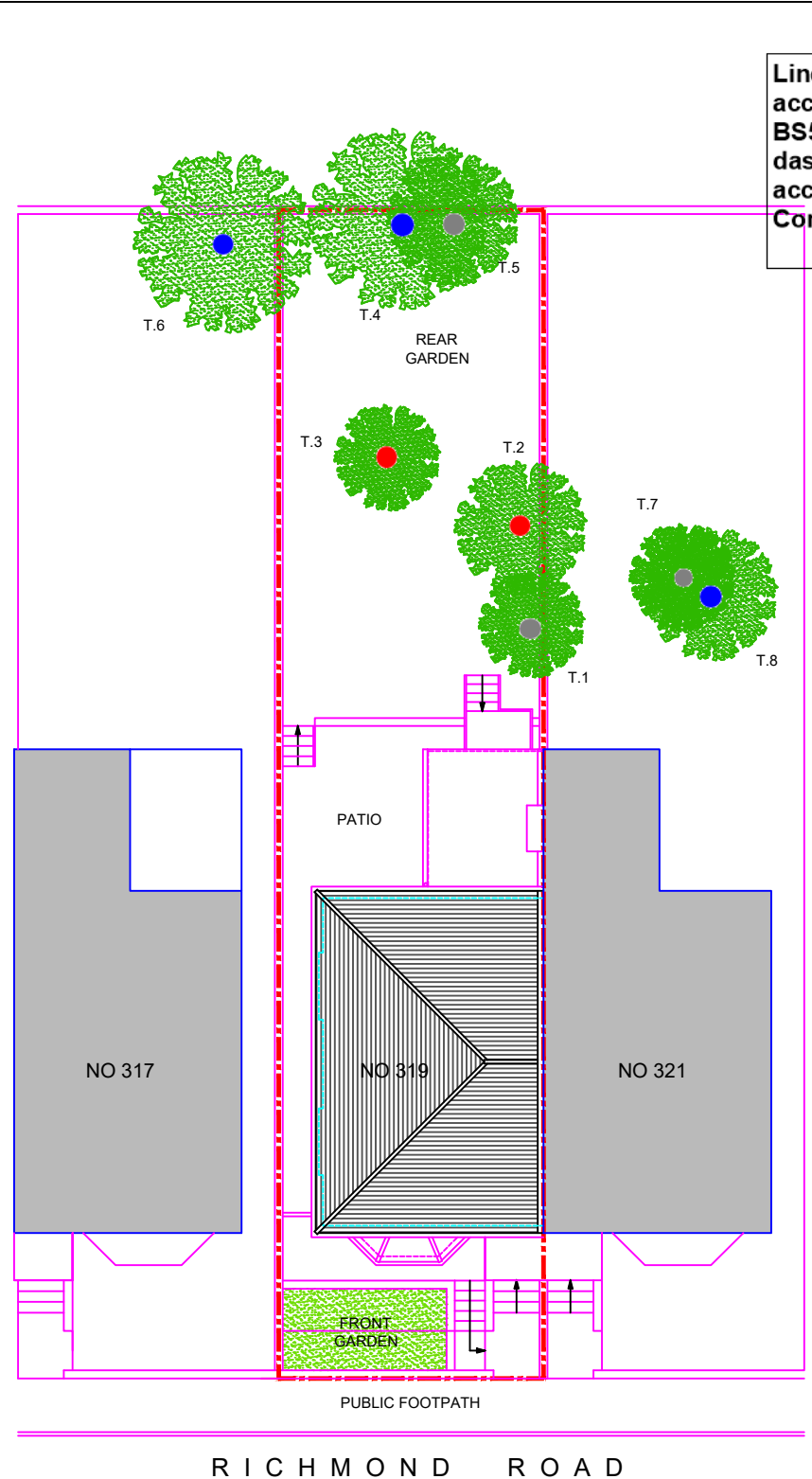

EXISTING BLOCK PLAN

Line of tree protective fencing in accordance with figure 2 of BS5837:2012 - shown by orange dashed line (with a gate to allow access for maintenance - no Contractor access permitted).

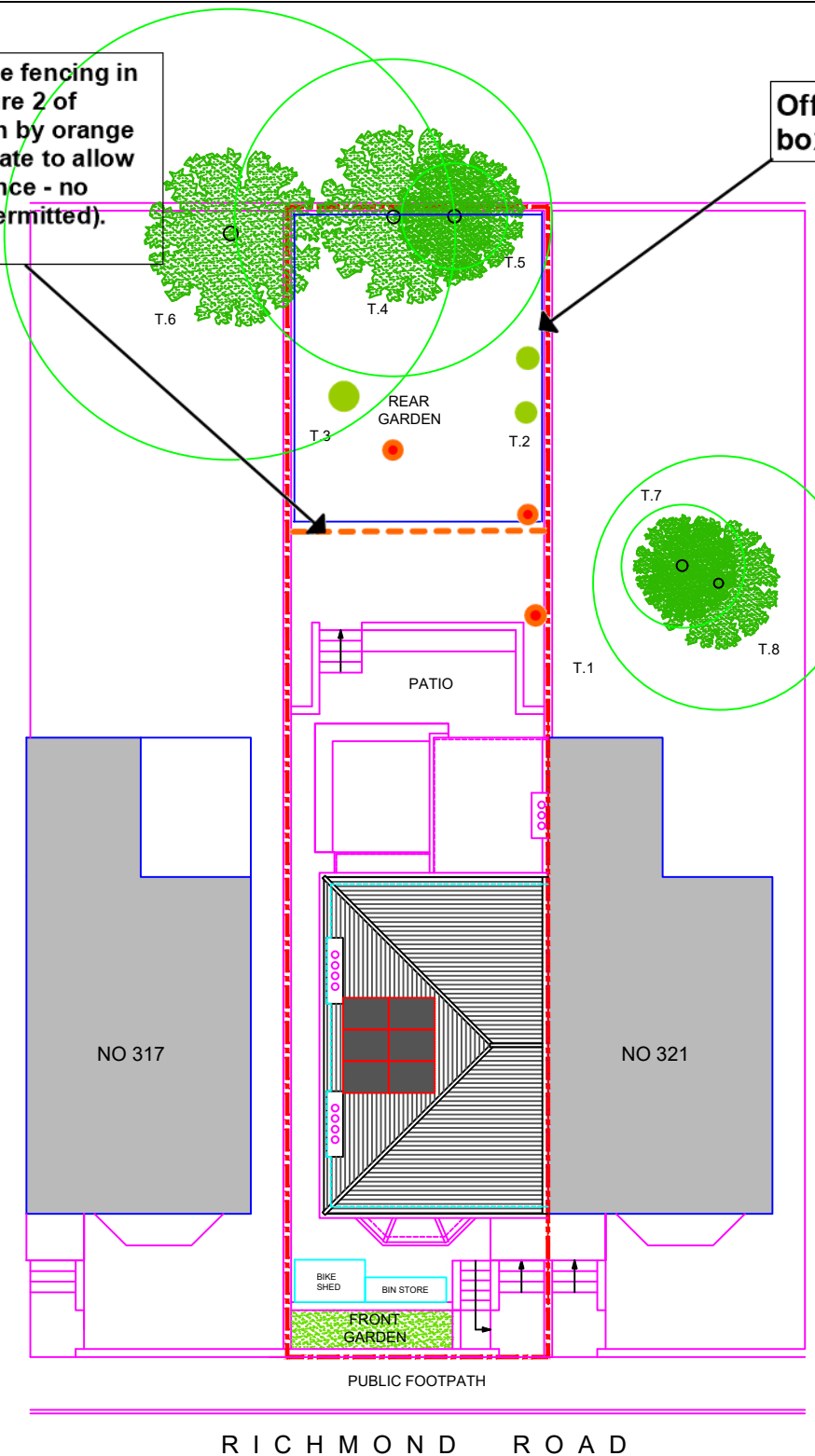

PROPOSED BLOCK PLAN

Offset RPA shown by blue box.

● = Trees to be removed.

Tree RPA's shown by green circles.

Approximate location of replacement trees (species - to be agreed with the Local Authority) of a minimum size of 'Standard' and using containerised stock.

REV DATE DESCRIPTION



PROJECT  
 PROPOSED CONVERSION FROM FLATS TO SINGLE HOUSE,  
 SINGLE STOREY REAR EXTENSION, WINDOW REPLACEMENT  
 AND SUNDRY ALTERATIONS  
 319 & 319A RICHMOND ROAD  
 TW1 2PB TWICKENHAM  
 DRAWING TITLE  
 EXISTING AND PROPOSED  
 BLOCK PLANS

DRAWING No (PL)01 SCALE 1:200@A3 DATE NOV'24

**Tree Location & Protection Plan.**  
 Clive Fowler Associates.  
 December 2024.  
 Originally produced in colour.  
 Scale as shown.

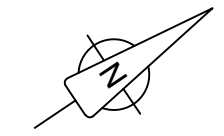

**NOTES**  
 THIS DRAWING IS THE COPYRIGHT OF THE ARCHITECT

