

LIGHTING KEY

- 4no Micro spike spot lights on separate series, Hudson Lighting. 2700K, 1w, or equivalent. Fitted with a anti glare guard. Unit to be placed 500mm from trunk.
- 4no wall lights, Pooky Kenobi ip65 wall light (£) or Blythe ip54 up and down wall light(££). 2 series
- 6no Mini Path marker light, 180 deg optic stainless steel, Hudson Lighting. 2700K, 1w. 2 series
- 2no wall (or ceiling spot lights),
- 4no Mini Path marker light, stainless steel, Hudson Lighting. 2700K, 1w. Dawn to Dusk settings? 1 series - client to confirm?
- 11no Path marker light, 90 deg, Hudson Lighting. 2700K, 2w or equivalent. Motion sensed?
- 2no Bollards, I series

14 series lighting plan. lights to be controlled from control box inside properties

1 FRONT + REAR GARDENS
Scale: 1:100



6 LOCATION PLAN
Scale: 1:500

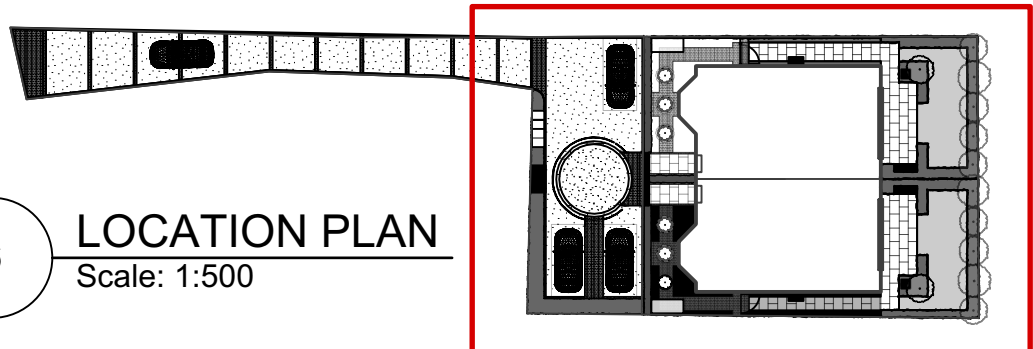

	TITLE: LIGHTING
	CLIENT: LONDON ROC
	PROJECT: AMYAND PARK ROAD, LONDON
	DATE: 23 AUG 2024
	SCALE: 1:100 @ A3
<p><small>General Notes: It is the contractors responsibility to ensure that design principles, calculations, drawings and final construction must conform to current building regulations, CDM regulations & codes of practice where relevant. All dimensions must be checked on site and not scaled from this drawing. Client to ensure all planning permissions and party wall agreements are in place before work starts. Design intent only.</small></p>	