

**LEGEND**

- Denotes existing structure
- Denotes structure to be demolished
- Denotes structure under
- 150 x 50 timber joists, C24 @ 400c/c with 18mm ply glued and screwed to top
- 175 x 50 timber joists, C24 @ 400c/c with 18mm ply glued and screwed to top
- 200 x 50 timber joists, C24 @ 400c/c with 18mm ply glued and screwed to top
- 200 x 63 timber joists, C24 @ 400c/c with 18mm ply glued and screwed to top
- Doubled/Tripled/Quadruple up joist (bolted together as per SDS spec)
- Timber post - 2No. 100x50 C24 Posts bolted with M12s at 400mm centres
- Load bearing timber wall with 150x50, C24 timber studs at 400mm centres
- Existing joist span - TBC on site
- Min 125hkc RC ground bearing slab cast onto min 150thk well compacted sub-base. Use A393 mesh in top (50mm cover)

- 1200mm long heavy duty lateral restraint straps cast into masonry using concrete and fixed to noggins between joists as per SDS specification
- Denotes position of crank
- Denotes moment connection

**PADSTONE SCHEDULE:** PSF

PS1	440mm long x 100mm wide x 215mm tall MC Padstone
PS2	330mm long x 100mm wide x 150mm tall MC Padstone.
PS3	215mm long x 215mm wide x 150mm tall MC Padstone.
PS4	440mm long x 215mm wide x 215mm tall MC Padstone.
SP1	440mm long x 100mm wide x 20mm thick MS plate.

**LINTEL SCHEDULE:** New lintel over opening. All lintels to have min. 150mm bearings UNO.

LN1	R15A Supreme precast prestressed concrete lintels (1No per 100mm wall thickness)
LN2	R22A Supreme precast prestressed concrete lintels (1No per 100mm wall thickness)
LN3	CN71A CATNIC Solid wall lintel
LN4	R22A Supreme precast prestressed concrete lintels (1No per 100mm wall thickness) to inner leaf/ New brick architectural lintel outer leaf
LN5	CCA Catnic Standard Arch Lintel

**COLUMN SCHEDULE**

REF	SIZE	GRADE
C1	SHS100x100x6.3	S355
C2	RHS150x100x10	S355
C3	UC203x203x86	S355
C4	RHS160x80x10	S355

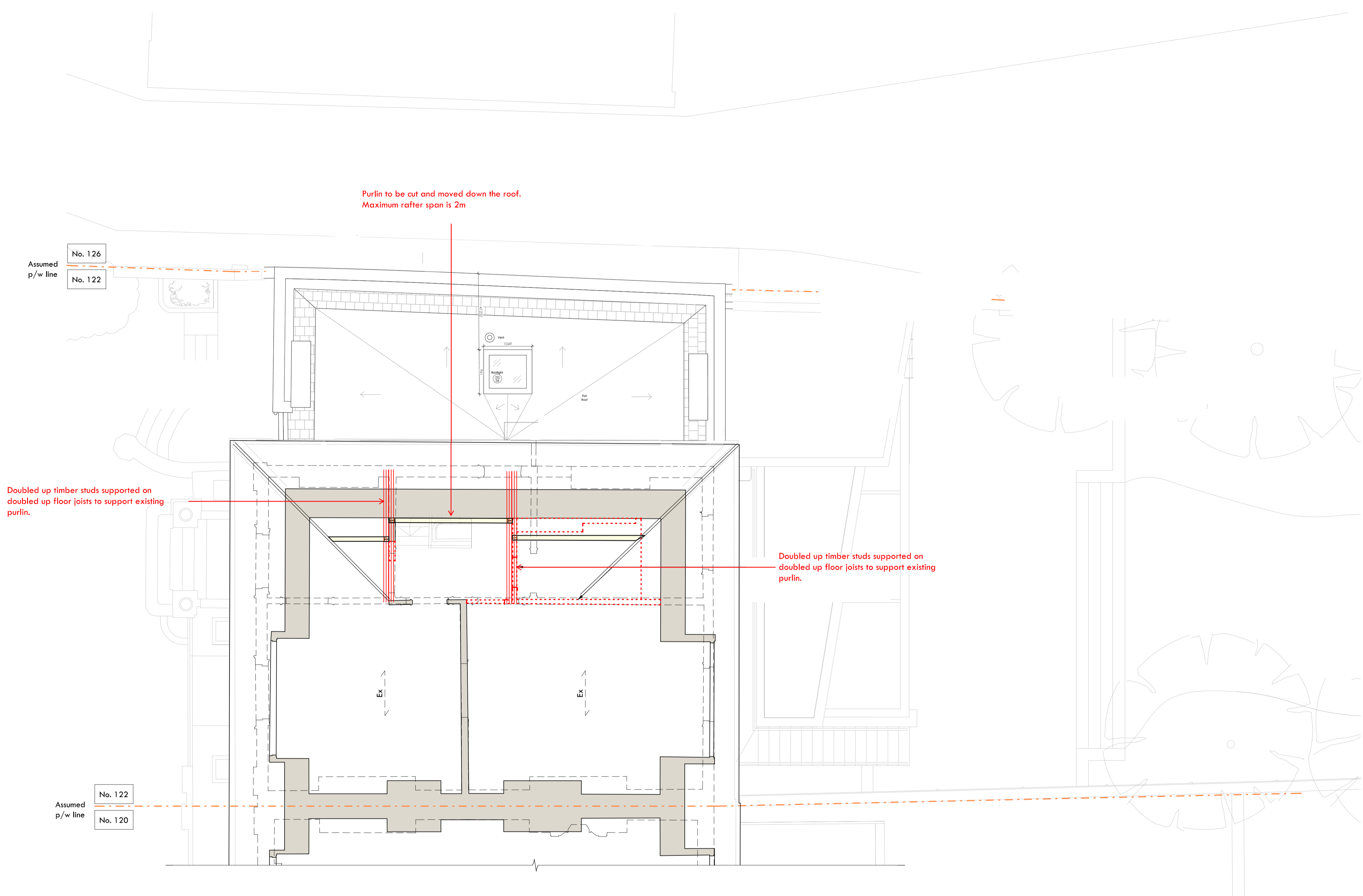

- Drawing Notes:**
- These drawings are not to be used for setting out purposes. Refer to the latest Architects information and site measure as required.
  - Contact Structural Design Studio Ltd in the event of any discrepancies between findings on site and these drawings.
  - Drawing is to be read in conjunction with the Structural Design Studio Ltd Specification and General Notes.
  - 3D views are indicative only and any conflicting 2D information should take precedence. If in doubt contact Structural Design Studio Ltd prior to starting work

Studio 3, Eastfields Ave, SW18 1GN  
 020 8191 8688 | www.structuraldesignstudio.co.uk

PO3	Issued for Tender	19.01.2024	CR	SW
PO2	Issued for Tender	30.11.2023	CN	SW
PO1	Issued for Information	08.09.2023	CN	SW
Rev	Amendment	Date	Drawn	Eng

TENDER			
Client	Date		SEPT 2023
Project Name	122 Castelnau, SW13 9EU	Eng	SW
		Drawn	CN
		Scale	1:50 @A1
Drawing title: <b>Second Floor Plan</b>			
Project Number	222083	Drawing Number	S- 120
Rev			<b>P03</b>