

**JOHN CROMAR'S
ARBORICULTURAL
COMPANY
LIMITED**

THE OLD SCHOOL,
TITLEY, KINGTON,
HR5 3RN.
at Wheatley, Oxford
& Harpenden, Herts.

TEL 01582 808020
FAX 01544 231006
MOB 07860 453072
admin@treescan.co.uk
www.treescan.co.uk



**KEY TO COLOURS /
LINETYPES USED IN
RELATION TO TREES**

- GREEN - High Value (A)
- BLUE - Moderate Value (B)
- BLACK - Low Value (C)
- RED - Very short life expectancy (U)
- ORANGE SHAPES: Root Protection Areas

Spread and trunk colours correspond directly to those used in British Standard 5837:2012, Table 2.

TOOTHED LINE: Tree spread line

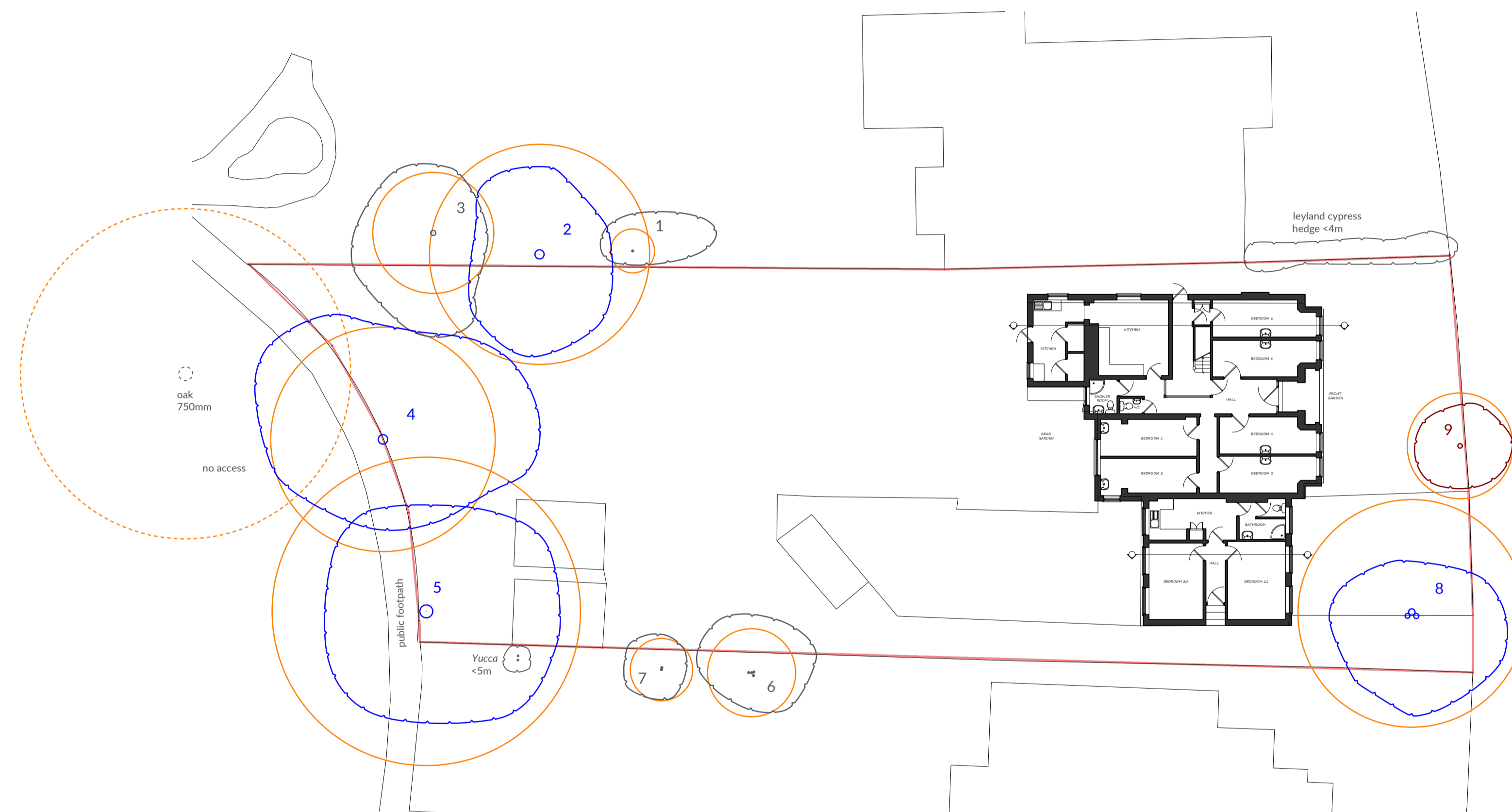

DRG. NAME
**TREE VALUE
ASSESSMENT
(AS PER BS
5837:2012) &
ROOT
PROTECTION
AREAS**

NOTES
Do not use for setting out purposes.
All dimensions to be checked on site.

Any scale referenced below applies ONLY when plan printed at ISO A1 size.

The original of this drawing was produced in colour - a monochrome copy should not be relied upon.

TEXT
FOR FULL DETAILS OF TREE VALUE
PLEASE SEE REPORT

BASED ON
MZA PLANNING DRG. NO.: 547-EXT-05
EXISTING BLOCK PLAN, 591-EXT-01
EXISTING GF PLAN SUPPLIED

SITE ADDRESS
16 Strawberry Hill Road, TW1 4PT

DRG. REF.	REV. NO.
S1392-J1-P1	v1
SCALE & SIZE	DATE
1:200 @ A1	26-Jul-24
0	5 10

