

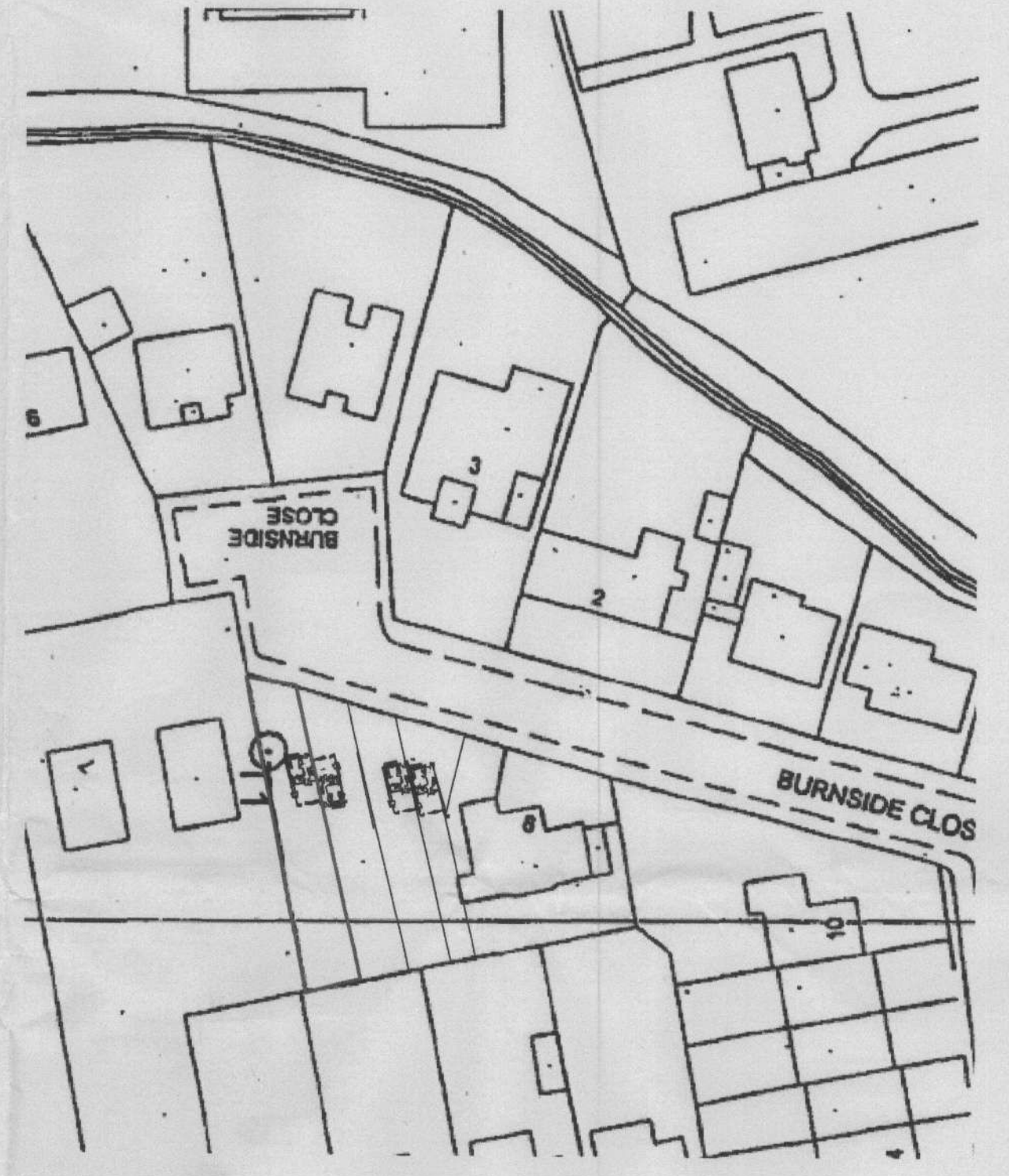

07/470/HOT

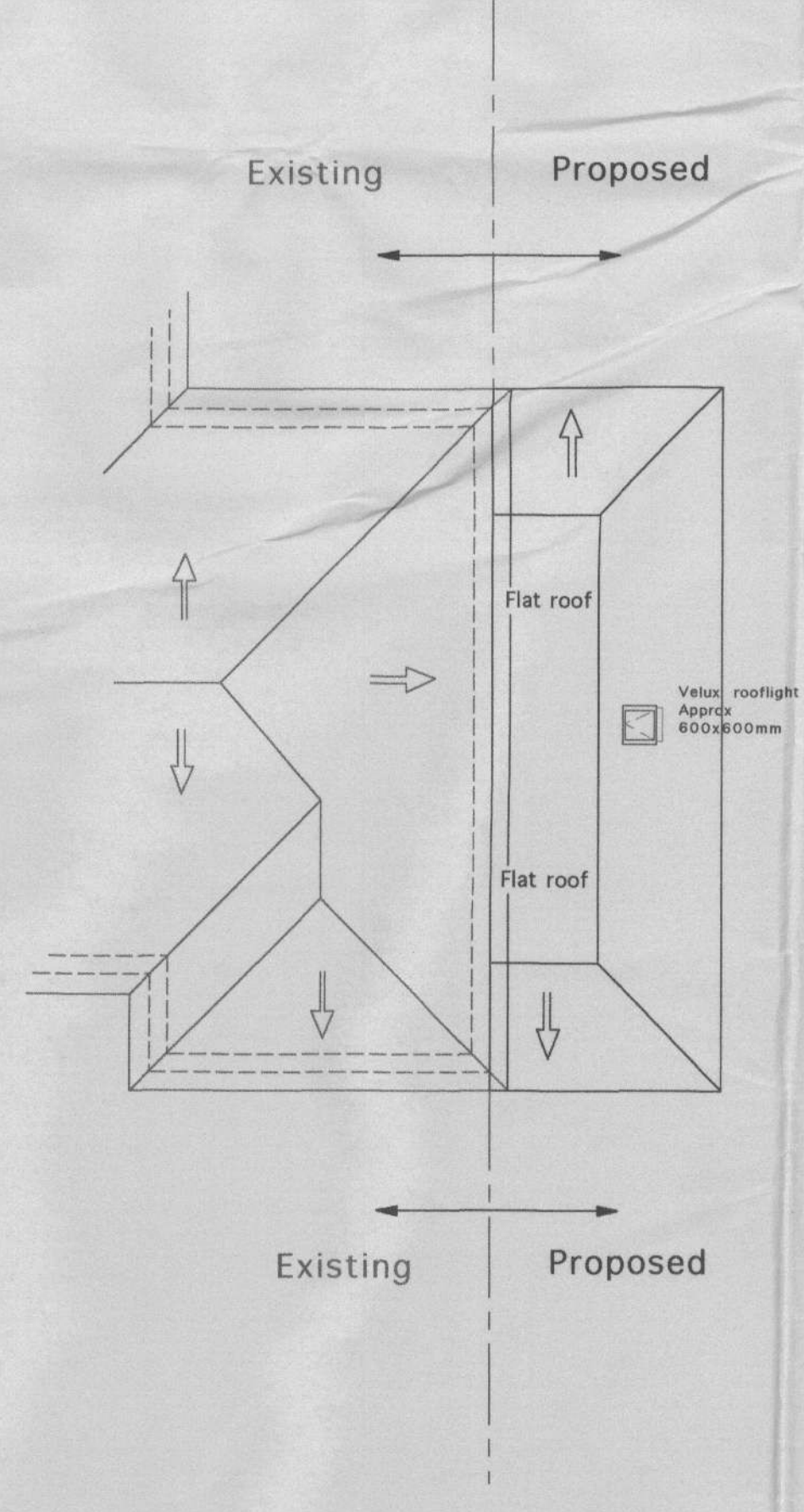
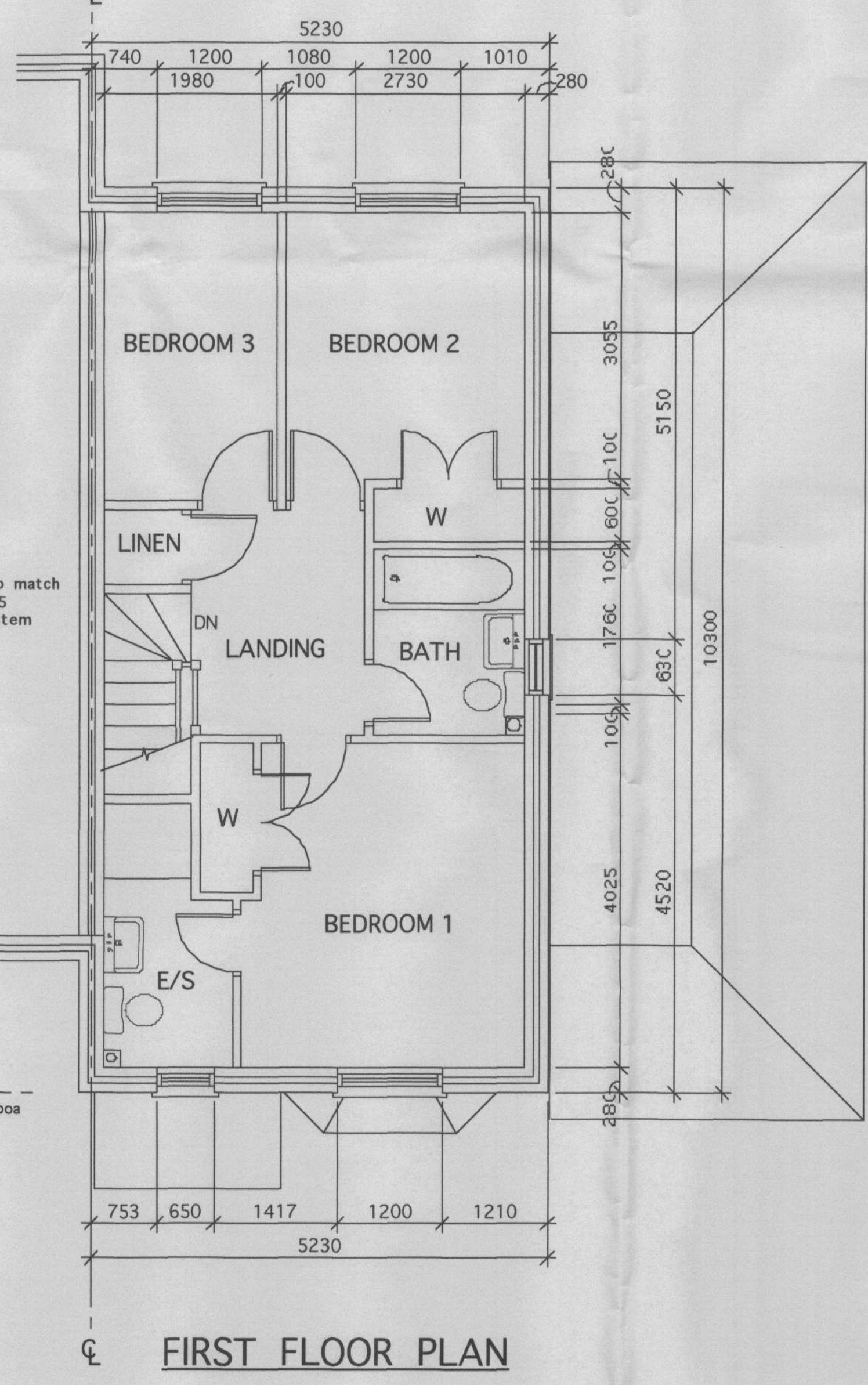
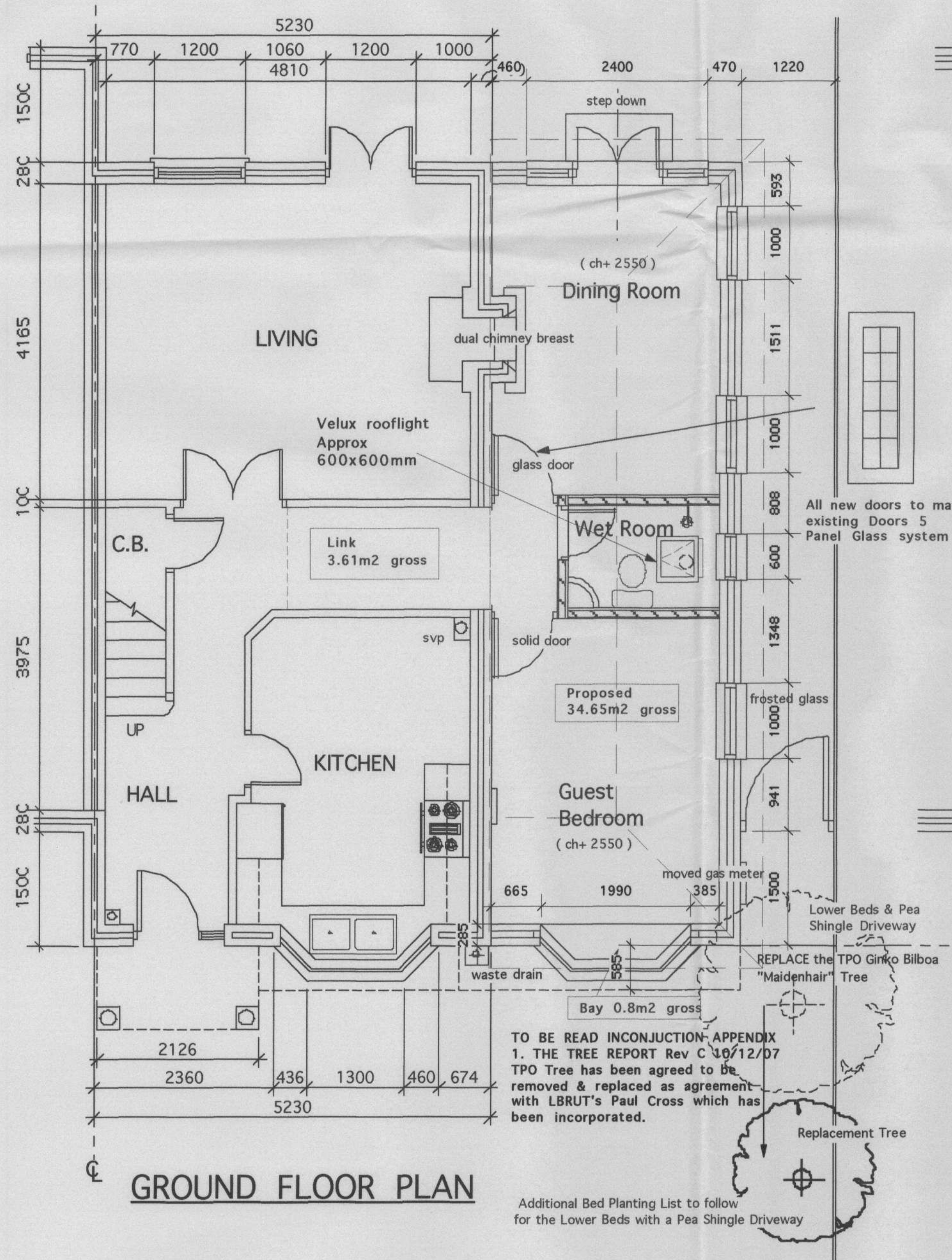

LOCATION PLAN 1:1250

Rev C 10/12/07 Tree Company Report received via client ArbTech's Andrew Turbull agreement with Paul Cross has been incorporated.
 Rev B 24/10/07 Client requested revised elevations & internal Tree Company Report requested via ArbTech's Andrew Turbull.
 Rev A 10/7/07 Client requested revised elevations added to current LBRUT Pre-application

Revisions:
 Client: **RECEIVED**
 24 DEC 2007
 Mr & Mrs Julian Ede **PLANNING**

Title: **Planning Submission**
 9B Burnside Close
 Twickenham
 Middlesex
 TW1 1ET
 H)Tel 020 8892 4445
 W)020 7955 7444

ENGLISHAUS
 Tel: +44 (0) 208 285 0595
 Fax: +44 (0) 208 287 3441
ENGLISHAUS LIMITED
 © EnglishHaus 1995