209 Waldegrave Road Teddington Middlesex TW11 8LX

UPRN: 100022327935
Area: 1325.503 m²

ORN: 000T0NKAPV000
Perimeter: 159.836 m

Ward: Teddington
BC Area:
DC Area:

Conservation Area: None

Shopping Frontage: None

Listed Buildings & BTMs:

1 BTM Approved: 15/09/1983 PH

Tree Preservation Orders:

1	TPO no: 706	Tree: T1	Condition: NK	Species: Eucalyptus gunnii Cider Gum
2	TPO no: 706	Tree: T2	Condition: NK	Species: Acer pseudoplatanus Sycamore

UDP Overlays and Constraints:

POS Deficient		Part Only
Mixed Use	Waldegrave Road Teddington	Part Only
Proposed For Environmental Improvement		[Inside Polygon]
Past Industrial Land Use		Part Only
Past Industrial Land Use		Partly In 10m Buffer

Report Ends.

209 Waldegrave Road Teddington Middlesex TW11 8LX

UPRN: 100022327935
Area: 1325.503

ORN: 000T0NKAPV000
Perim: 159.836

DC 07/3470/FUL

Officer: Mrs Polly Davidson

Received: 05/10/2007

Status: No Decision (.)

*Refurbishment of existing public house retaining the A4 use class at ground floor with 3 flats at upper floors.
Construction of two new 3 storey buildings comprising of 19 flats with associated parking for 20 cars.*

DC 07/0299/FUL

Officer: Mr Bryan Staff

Received: 03/04/2007

Status: WDN withdrawn by the applicant 16/08/2007 (WDN).

*Refurbishment of existing public house retaining the A4 use class at ground floor with 3 flats at upper floors.
Construction of two new 3 storey buildings comprising of 19 flats with associated parking for 20 cars.*

DC 99/3227

Officer: Miss Bernadette Sheehan

Received: 23/12/1999

Status: GTD granted permission 11/02/2000 (DEL).

Erection Of External Signage And Associated Illumination.

DC 99/3199

Officer: Miss Bernadette Sheehan

Received: 20/12/1999

Status: GTD granted permission 01/02/2000 (DEL).

Form New Pitched Roof And Extend Canopy Over Existing Flat Roofside Entrance Porch.

BC 94/1115/FP

Officer: Mr Malcolm Hill

Received: 10/08/1994

Status: Decision: DEC Decided (no details) 09/09/1994. Status: BST Building Work Started.

Formation of new ladies' toilet and internal alterations

DC 94/1927/FUL

Officer: Mr Simon Graham-Smith

Received: 10/08/1994

Status: GTD granted permission 23/09/1994 (.)

Erection Of Lantern To Front Elevation

DC 94/1816/ADV

Officer: Mr Simon Graham-Smith

Received: 28/07/1994

Status: GTD granted permission 22/09/1994 (.)

Erection Of Externally Illuminated Fascia, Projecting And Amenity Board Signs

Report Ends.

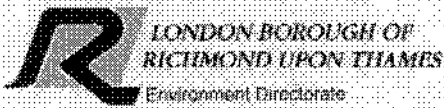
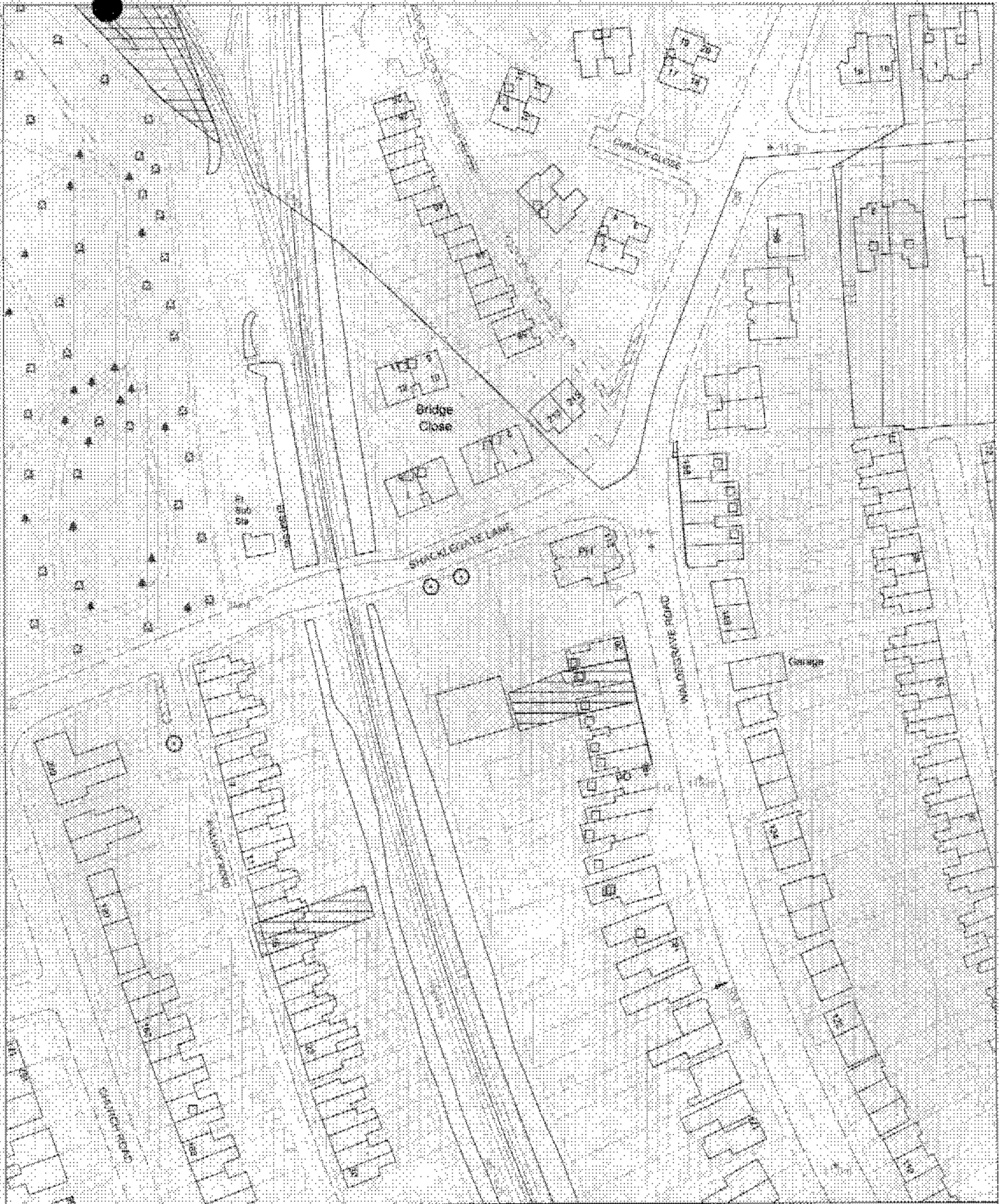

Ordnance Survey Map Extract

Reproduced from Ordnance Survey material with permission of Ordnance Survey on behalf of the Controller of Her Majesty's Stationary Office. (c) Crown Copyright. Unauthorized reproduction infringes Crown Copyright and may lead to prosecution or civil proceedings. London Borough of Richmond upon Thames LA 100019441 2007 For reference purposes only. No further copies may be made.

CIVIC CENTRE, 44 YORK STREET
TWICKENHAM, TW1 3BZ.
TEL. 020 8891 1411, TEXTPHONE: 020 8891 7120.
www.richmond.gov.uk

Co-ordinates at centre of map:
Easting: 315557 Northing: 171721

Scale	Date	Section	Drawn
1: 1250	16/10/07	TS	SH



Produced using Datamap, the directorate's Geographic Information System (GIS).

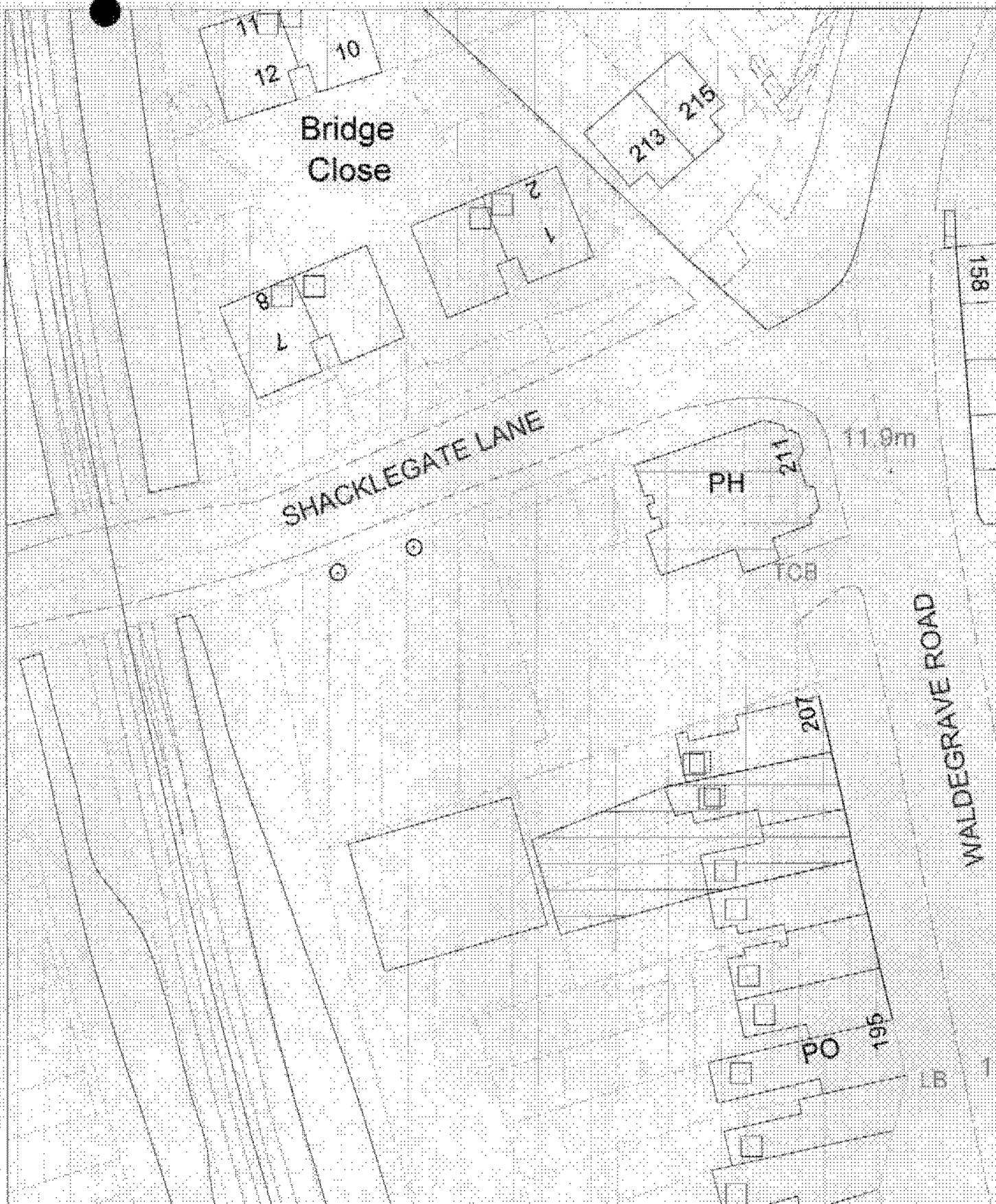

**Ordnance Survey
Map Extract**

Reproduced from Ordnance Survey material with permission of Ordnance Survey on behalf of the Controller of Her Majesty's Stationary Office.
 (c) Crown Copyright.
 Unauthorised reproduction infringes Crown Copyright and may lead to prosecution or civil proceedings.
 London Borough of Richmond upon Thames
 LA 100019441 2007
 For reference purposes only.
 No further copies may be made.

CIVIC CENTRE, 44 YORK STREET
 TWICKENHAM, TW1 3BZ
 TEL: 020 8891 1411, TEXTPHONE: 020 8891 7120
 www.richmond.gov.uk

Co-ordinates at centre of map: Easting: 515557 Northing: 171721			
Scale	Date	Section	Drawn
1:500	16/10/07	TS	SH



Produced using Detamap, the directorate's Geographic Information System (GIS)

ROAD

5710P
WALDEGRAVE RD TEDDINGTON

No. 2097

Plan No.	Particulars	Applicant	Council's Decision	APPEAL	Date
2057/47 72/17/47 446/A.	NOT PROCEEDED WITH.		Approved		
94/181/00V	CREATION OF GREENWAY ILLUMINATED FASIA, PLANTING & ANCHOR BOARD SIGNS PAMBROOK DESIGN OF SCOTTISH NEWCASTLE		AJWC 22/9/94		
94/192/00V	CREATION OF LARGENTO FLANT GREENWAY PAMBROOK DESIGN OF SCOTTISH NEWCASTLE		AJWC 23/9/94		

ROAD

No.

Plan No.	Particulars	Applicant	Council's Decision	APPEAL	Date