

03/1855/FAL

Rev	Date	By	Amendment
B	01/08/03	Juan	Roof Plan Updated Taking Into Account The New Third Floor Layout Plans.

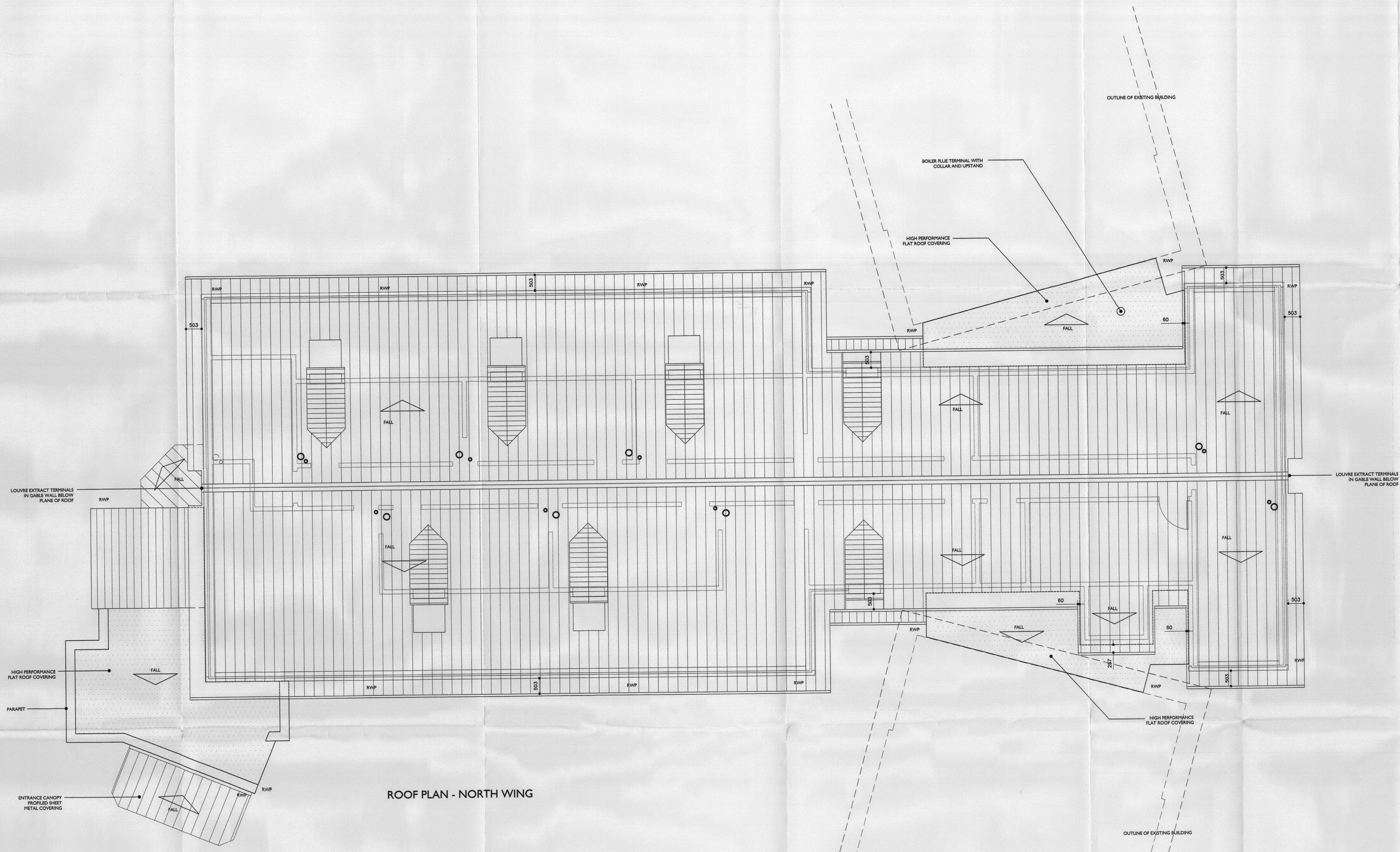

ROOF PLAN - NORTH WING

LEGEND

OFFICE COPY
 DO NOT REMOVE FROM FILE

TRIBAL
 Property Services
 A member of Tribal Group PLC

ASH DESIGN
 CHARTERED ARCHITECTS
 LONDON
 RIVERSIDE OFFICES, BLOCK A, LITTLEBROOK BUSINESS PARK,
 CHARTFORD, HERT DA1 5PZ
 Tel: 01322 627900 E-mail: ash@tribalpb.co.uk
 Fax: 01322 290155 Website: www.tribalpb.co.uk
 BRISTOL
 1 PORTLAND SQUARE,
 BRISTOL, BS2 0PR
 Tel: 0117 311 5482 Fax: 0117 311 5422
 LEEDS
 SUITE 1, CRIMSTON GRANGE OFFICES,
 SHERBURN ROAD, TADCASTER, LE5A 9BX
 Tel: 01937 549777 Fax: 01937 539312

Client St. MARY'S COLLEGE TWICKENHAM			
Project EXTENSIONS AND ALTERATIONS TO GWD ACCOMMODATION			
Drawing ROOF PLAN NORTH WING			
Date 14/04/04	Scale 1/50	Drawn by AO	Checked by
Project No 02644	Drawing No L(2)18	Revision B	