

Project No	Drawing No	Revision
02644	I(0)20	.

© ASH DESIGN CONSULTANTS LTD
 No part of this drawing may be reproduced without written consent. Do not scale from this drawing. All contractors must visit site and be responsible for taking and checking all dimensions relating to this work.

TRIAL
 A member of Tribid Group plc
 ISO 9001
 REGISTERED FIRM

Rev	Date	By	Amendment
-----	------	----	-----------

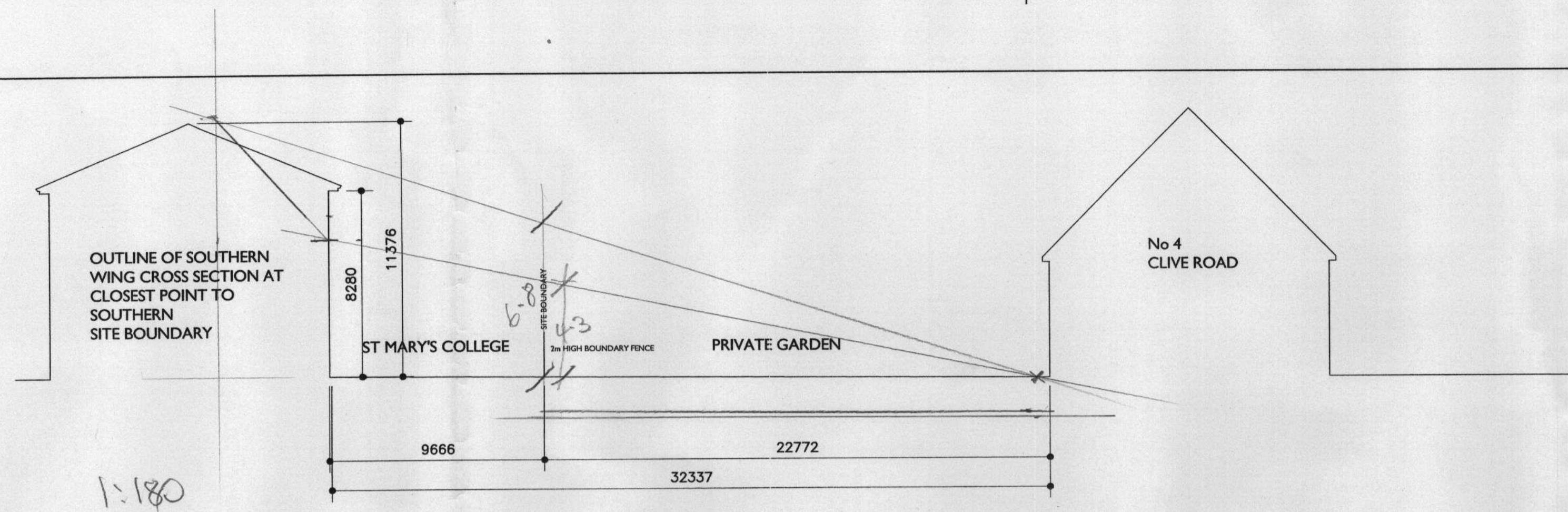

1:150 cross section number one

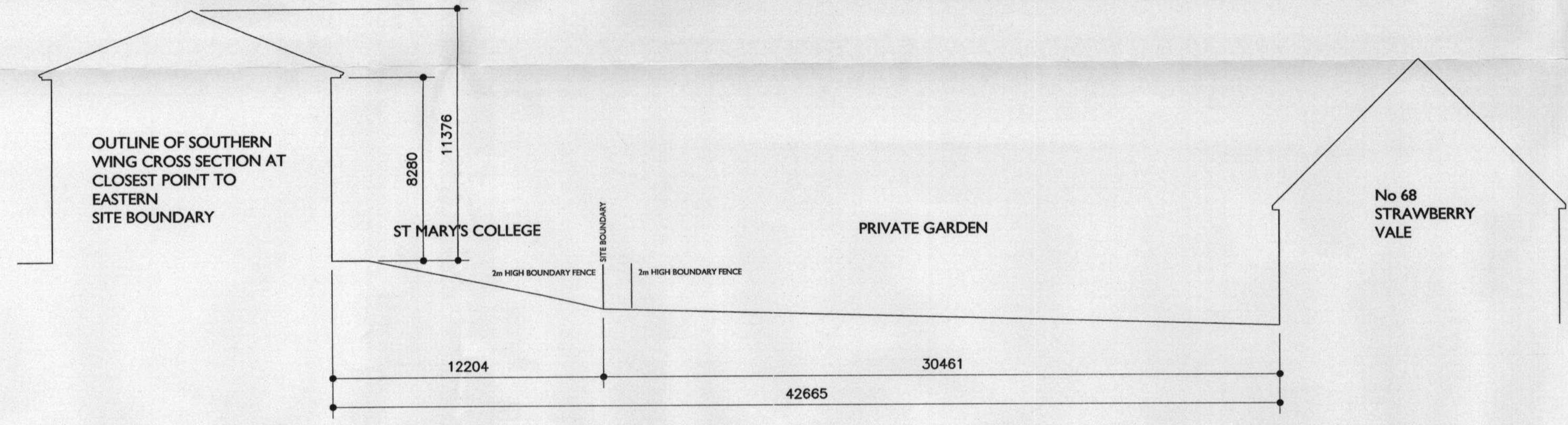

1:150 cross section number one

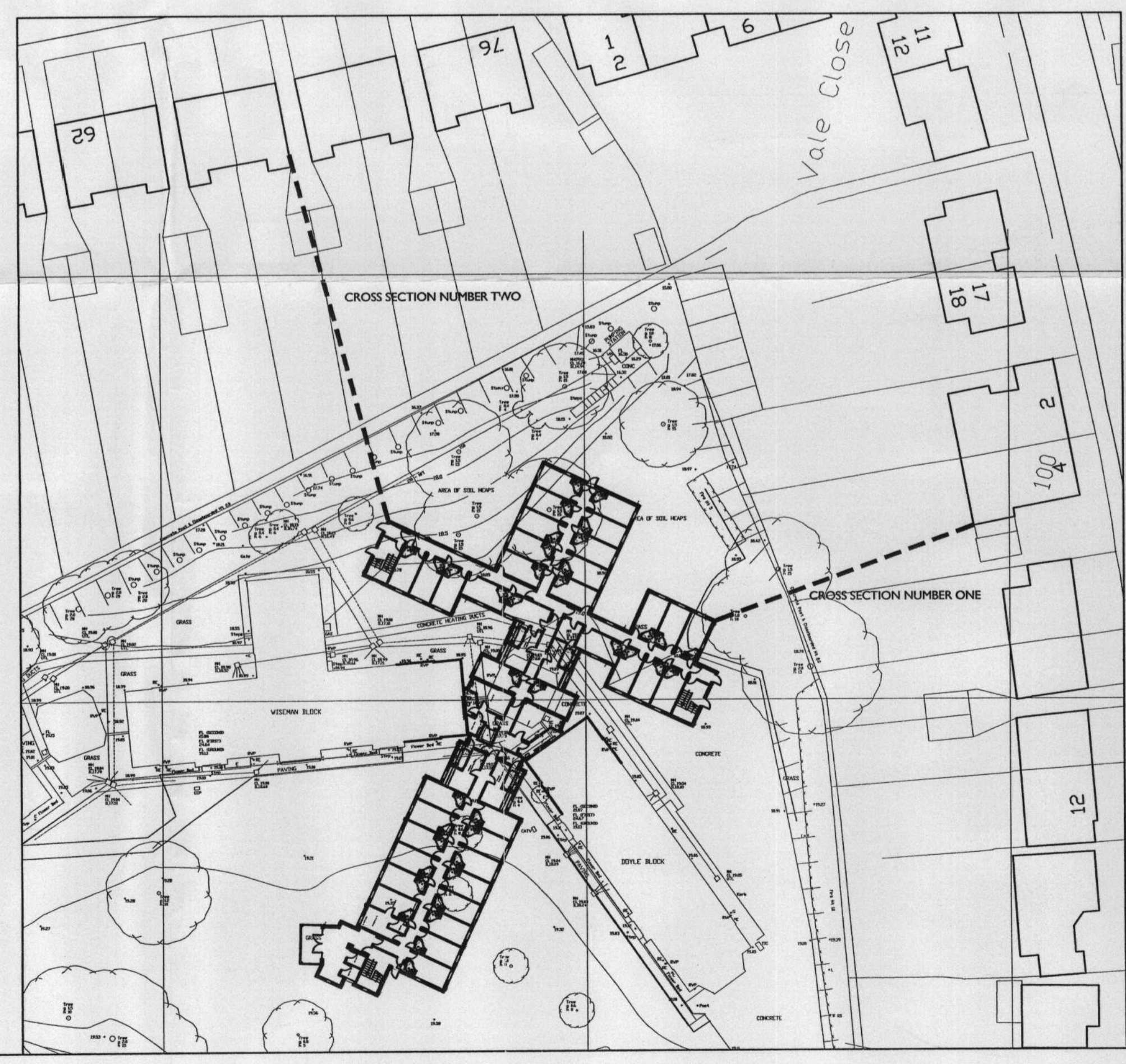

LEGEND

03/1855/
 ASH DESIGN
 CHARTERED ARCHITECTS

RIVERSIDE OFFICES, BLOCK A, LITTLEBROOK BUSINESS PARK, DARTFORD, KENT DA1 5PZ
 Tel: 01322 627800 E-mail: adcl@TribalPS.co.uk
 Fax: 01322 290155 Website: www.TribalPS.co.uk

SUITE 1, GRIMSTON GRANGE OFFICES, SHERBURN ROAD, TADCASTER, NORTH YORKSHIRE LS24 9BX
 Tel: 01937 833975 E-mail: tpsn@TribalPS.co.uk
 Fax: 01937 833512 Website: www.TribalPS.co.uk

Client
 ST MARY'S COLLEGE
 TWICKENHAM

Project
 EXTENSIONS AND ALTERATIONS
 TO GWD ACCOMMODATION

Drawing
 SITE
 CROSS SECTIONS

Date	Scale	Drawn by
13/06/03	VARIOUS	JB
Checked by		

Project No	Drawing No	Revision
02644	I(0)20	.

OFFICE COPY
 DO NOT REMOVE FROM FILE