

WOODLAND No 2

TREES:-

- A - EXISTING TREES (3/4).
- C - BETULA PENDULA 'LACINIATA' (1).

SHRUBS:-

- 1 - MAHONIA x MEDIA 'CHARITY' (4)
- 2 - PYRACANTHA 'WATEREI' (2)
- 3 - VIBURNUM OPULUS 'ROSEUM' (3)
- 4 - HYDRANGEA PANICULATA 'GRANDIFLORA' (4)
- 5 - SARCOCOCCA CONFUSA (5)
- 6 - GAULTHERIA MUCRONATA 'SNOW WHITE' (5)
- 15 - DAPHNE ODORA 'AURUMARGINATA' (6)
- 16 - LEYCESTERIA FORTIOSA (3)
- 17 - ROSA CANINA (7)

PERENNIAL & FERN:-

- 7 - DIGITALIS PURPUREA 'ALBAFLORA' - SPACING - 5m APPROX (20)
- 8 - IRIS FORTIDISSIMA - SPACING - SPACING - 4.5m APPROX (6)
- 9 - HELLEBORUS FARGUTIFOLIUS - SPACING - 5m APPROX (15)
- 10 - DRYOPTERIS FELIX - FRAS (3)

GROUND COVER:-

EXISTING HEDERA - TRANSPLANTED.

CLIMBERS:-

- 12 - HEDERA CANARIENSIS 'GLOIRE DE THOUROU' (2)
- 13 - HYDRANGEA PETIOLARIS (2)
- 14 - CLETIATA VITICELLA 'THADAE JULIA CORREYON' (2)
- 15 - ROSA 'LITTING MILE BRUNNER' (2)

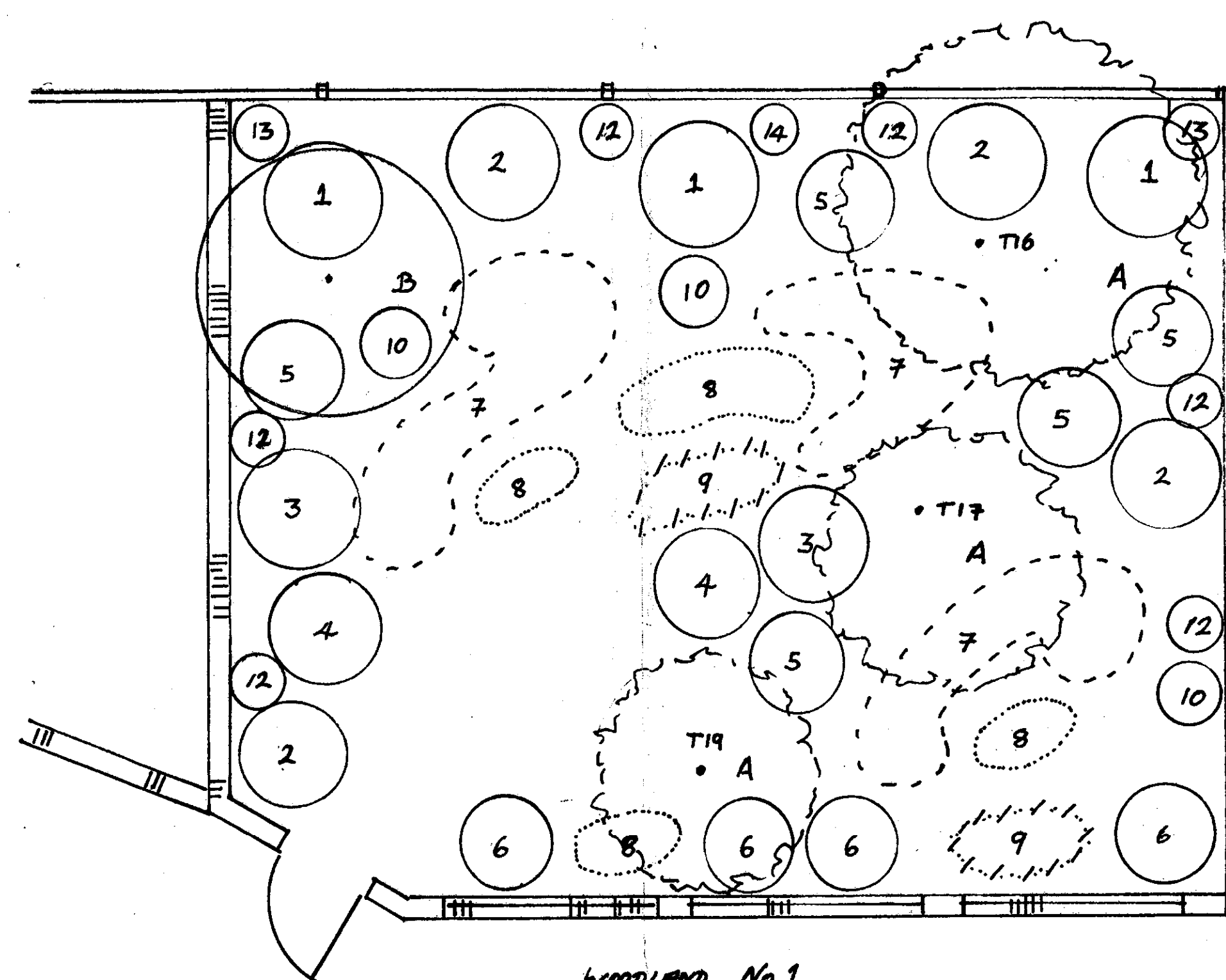

WOODLAND No 1

TREES:-

- A - EXISTING TREES (3)
- B - SALIX FRAGILIS (1)

SHRUBS:-

- 1 - MAHONIA x MEDIA 'CHARITY' (3)
- 2 - PYRACANTHA 'WATEREI' (4)
- 3 - VIBURNUM OPULUS (2) 'ROSEUM'
- 4 - HYDRANGEA PANICULATA 'GRANDIFLORA' (2)
- 5 - SARCOCOCCA CONFUSA (5)
- 6 - GAULTHERIA MUCRONATA 'SNOW WHITE' (4)

PERENNIAL & FERN:-

- 7 - DIGITALIS PURPUREA ALBAFLORA (33)
- 8 - IRIS FORTIDISSIMA (18)
- 9 - HELLEBORUS FARGUTIFOLIUS (9)
- 10 - DRYOPTERIS FELIX - FRAS (3)

GROUND COVER

EXISTING HEDERA - TRANSPLANTED.

CLIMBERS:-

- 12 - HEDERA CANARIENSIS 'GLOIRE DE THOUROU' (6)
- 13 - HYDRANGEA PETIOLARIS (2)
- 14 - CLETIATA VITICELLA 'THADAE JULIA CORREYON' (1)

GROUND COVER:-

EXISTING HEDERA - TRANSPLANTED.

BULBS:-

- TO BOTH WOODLAND BORDERS 1 + 2.
- PLANTED IN SPACES BETWEEN SHRUBS + PERENNIALS -
- NARCISSUS 'GERANIUM' - SPACING 10-15cm (300)
- NARCISSUS 'ORANGEY' - SPACING 10-15cm (300)
- GALANTHUS NIVALIS 'POOPY GREEN TIP' - SPACING 10cm (250)
- GALANTHUS 'S. ARNDT' - SPACING 10cm (250)
- ANEMONE NEMOROSA 'ROBINSONIANA' - SPACING 10cm (500)

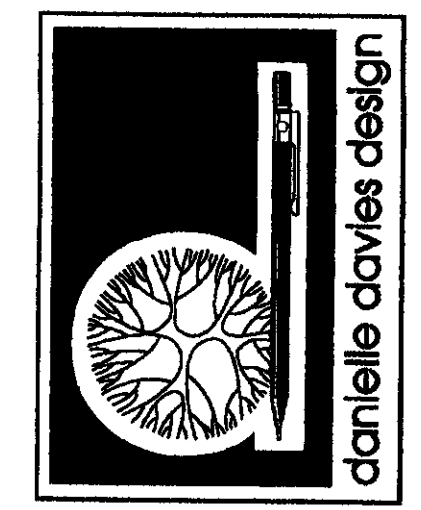

80 STATION ROAD  
HAMPTON - MIDDLESEX  
TW12 2AX

DW. No 004

Project - TWICKENHAM RIVERSIDE

Client - RICHMOND BOROUGH COUNCIL

Detail - WOODLAND BORDERS No 1 + 2

Scale - 1:50

Date - 8<sup>th</sup> October '03

North

t: 020 8979 7878  
f: 020 8979 8118  
e: info@greenscheme.com  
w: www.greenscheme.com

LONDON BOROUGH OF  
RICHMOND UPON THAMES  
09 SEP 2004  
PLANNING

Do Not Scale From Plan