

RECEIVED  
- 2 APR 2009  
PLANNING

09/0782/LBC

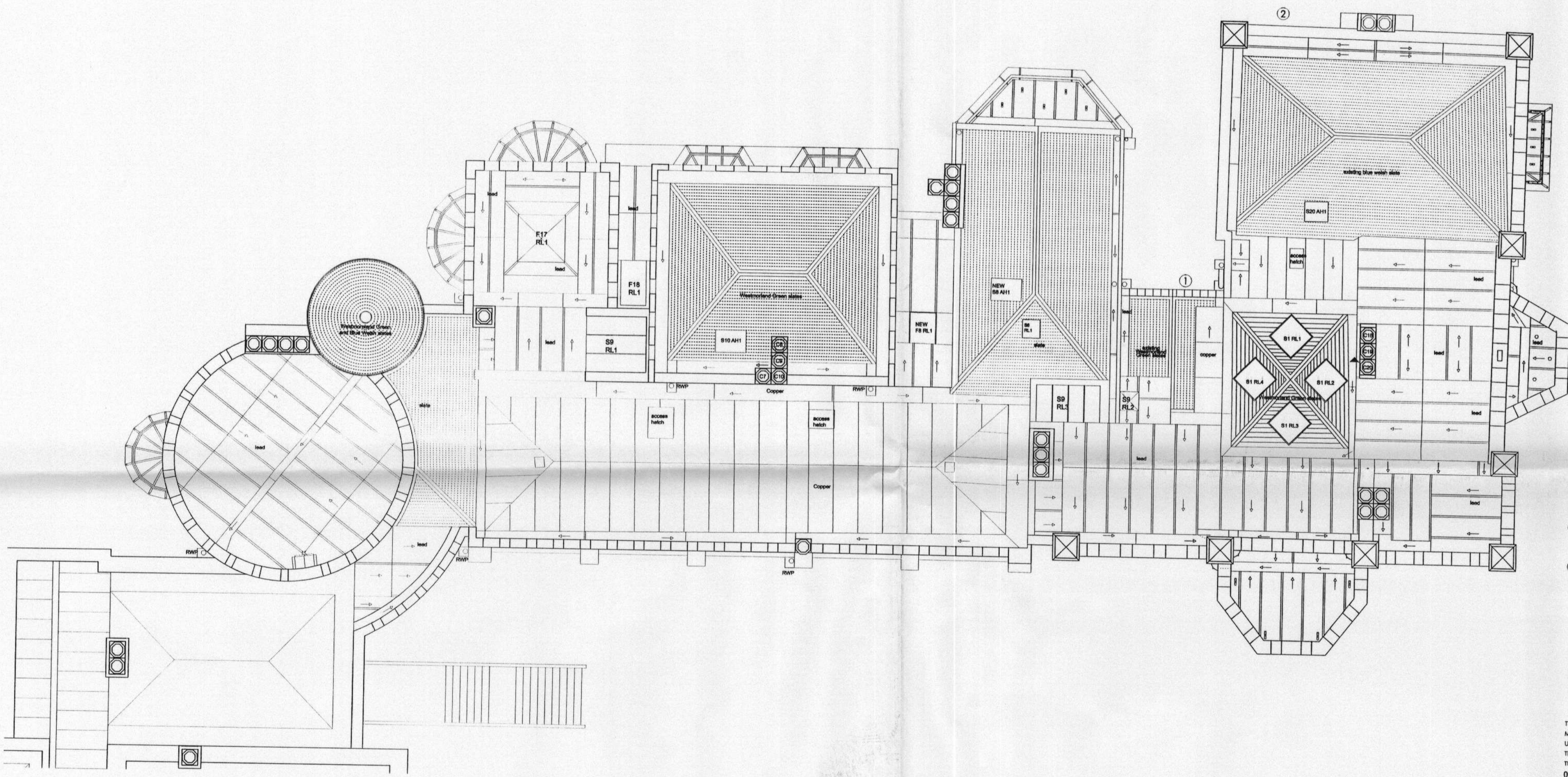

- ① Dismantle 1950s crenellated parapet (yellow brick in cement mortar) and reinforced concrete copings.
- ② Remove 1980s crenellated parapet (brick in cement mortar) to restore original parapet skyline.

DISMANTLING

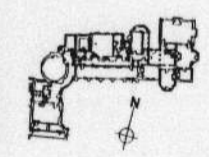

THIS DRAWING IS COPYRIGHT PETER INSKIP + PETER JENKINS ARCHITECTS LTD AND MUST NOT BE USED FOR PURPOSES OTHER THAN IN RELATION TO THIS PROJECT UNLESS AUTHORIZED BY THE PRACTICE  
THIS DRAWING MUST NOT BE SCALED - WORK TO FIGURED DIMENSIONS ONLY  
THIS DRAWING MUST BE READ IN CONJUNCTION WITH THE SPECIFICATION

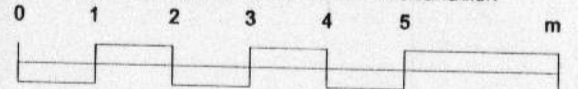

DATE	REVISION	COMMENT	AUTHOR	APPROVED
12.03.09	C	LIC & PLANNING	PI	SI
08.05.09	F	FOR LIC & PLANNING APPROVAL	PI	SI

**WALPOLE'S VILLA  
STRAWBERRY HILL HOUSE**

TITLE  
SECOND FLOOR PLAN AS APPROVED 06/1626  
+ 08/3453 & WITH STRIP OUT

DWG NO                      SCALE    1:100 @ A2  
SHT GA 016                      DATE    MAY 2006

PETER INSKIP + PETER JENKINS ARCHITECTS LTD  
19 - 23 WHITE LION STREET LONDON N1 9PD  
TELEPHONE 020 7332 4000 FAX 020 7332 2345