

DEVELOPMENT CONTROL

17/06/06

LOCATION: *St Mary's university College*
Waldegrave Road
Dunelmham

PENDING No. TEAM CASE OFFICER *CLH*

L.B. GRADE	
C.A.	
ADV. YES / NO	REASON
CAAC	

FEE	RECEIPT No.
REFUND	SITE NOTICE YES / NO
WARD	<i>STW</i>
LIBRARY	

EXPIRY DATE: <i>23.06.06</i>	WEEKLY LIST:
TARGET DATE:	DATE:
SPECIAL CTTEE INSTRUCTIONS:	

NOTES:

Appointment Tue 27/6/06.

06/50297/1100

Civic Centre, 44 York Street, Twickenham TW1 3BZ
tel: 020 8891 7300 text phone 020 8891 7120
fax: 020 8891 7789
email: trees@richmond.gov.uk
website: www.richmond.gov.uk

TOWN AND COUNTRY PLANNING (TREES) REGULATIONS 1999

C/o Catherine Birch
Ingleton Wood
434 The London Fruit And Wool
Exchange
Brushfield Street
London
E1 6EX

Please contact: Tree Department

Please telephone: 0845 612 2660

Your ref:

Our ref: 06/T0297/TPO

Letter Printed:

Dear Sir/Madam

Applicant:

Agent: Catherine Birch

WHEREAS in accordance with the provisions of the Town and Country Planning Act 1990 and the Orders made thereunder you have made an application(s) received on 28.04.2006 for permission of the Local Planning Authority to carry out works to (a) tree(s) on land situated at:

Location: St Marys University College, Waldegrave Road, Twickenham, Middlesex.

As described in the attached schedule

NOW THEREFORE WE THE MAYOR AND THE BURGESSES OF THE LONDON BOROUGH OF RICHMOND UPON THAMES acting by the Council of the said Borough, the Local Planning Authority, HEREBY GIVE YOU NOTICE pursuant to the said Act and Orders made thereunder that their decision on your application to carry out tree work(s) on the said land is as set out on the attached schedule.

Yours faithfully

Glen Harding
Acting Arboricultural Manager
Environment Directorate

APPLICANT NAME	AGENT NAME Catherine Birch Ingleton Wood 434 The London Fruit And Wool Exchange Brushfield Street London E1 6EX
-----------------------	--

SITE:

St Marys University College, Waldegrave Road, Twickenham, Middlesex.

PROPOSAL:

T1 - Yew (*Taxus baccata*) - Remove.

T2 - Sycamore (*Acer pseudoplatanus*) - Prune back.

T3 (T5 on plan) - Various - Prune back to improve vistas.

DETAILED CONDITIONS**U10410**

Your application for T1 - Yew was refused because the removal of this trees would be detrimental to public amenity and the amenity of the plaza.

U10411

Permission is however GRANTED for T1 - Yew to lift crown to 3 metres above ground level. Reduce small branches by 1 metre above bench to improve view of chapel.

U11296

Your application for T2 - Sycamore (*Acer pseudoplatanus*) was refused because the specification to prune back is non specific.

U11297

Permission is however GRANTED for T2 to lift the crown to 4 metres above ground level, clear the new lamp column by approximately 1 metre and remove deadwood.

U11298

Your application for T3 (T5 on plan) - Various was refused because the proposal to prune back to improve vistas is non specific.

U11300

Permission is however GRANTED for the following to T3 (T5 on plan) - Various:

Two Holly trees - Lift crown to 2 metres above ground level.

Two Birch trees - Lift crown to 2 metres above ground level.

Common Yew adjacent chapel - prune lateral branches to clear chapel-in-the-woods by up to 1 metre.

Italian Alder adjacent chapel-in-the-woods - Crown lift over pathways to 2.5 metres above ground level.

TP03 BS3998 (1989)

The proposed work is to be carried out to British Standard 3998 (1989) by a reputable tree surgeon to the satisfaction of the Tree Preservation Officer who should be informed of the date of commencement of work.

DETAILED INFORMATIVES

P02 Section 78 - Appeal

The applicant's attention is drawn to Section 78 of the Town and Country Planning Act 1990, by which an appeal may be made to the Secretary of State within 28 days of notification of this decision.

ADDITIONAL STANDARD INFORMATIVES

1. If you alter the proposals in any way a further application(s) will be required. Accordingly you should contact the Tree Preservation Officer of Environment |Planning and Review Department, Civic centre, 44 York Street, Twickenham TW1 3BZ.
2. You are advised that if you are not the owner(s) of the tree(s) the subject of the approval(s) that the permission of the tree owner(s) will be required prior to the commencement of work(s). Accordingly if you are not the owner(s) you should discuss the application(s) with them forthwith.

END OF SCHEDULE OF CONDITIONS AND INFORMATIVES FOR APPLICATION 06/T0297/TPO

^ST.IMAGE;

Civic Centre, 44 York Street, Twickenham TW1 3BZ
tel: 020 8891 7300 text phone 020 8891 7120
fax: 020 8891 7789
email: trees@richmond.gov.uk
website: www.richmond.gov.uk

TOWN AND COUNTRY PLANNING (TREES) REGULATIONS 1999

C/o Catherine Birch
Ingleton Wood
434 The London Fruit And Wool
Exchange
Brushfield Street
London
E1 6EX

Please contact: Tree Department

Please telephone: 020 8891 7300

Your ref:

Our ref: 06/T0297/TPO

Letter Printed:

Dear Sir/Madam

Applicant:

Agent: Catherine Birch

WHEREAS in accordance with the provisions of the Town and Country Planning Act 1990 and the Orders made thereunder you have made an application(s) received on 28.04.2006 for permission of the Local Planning Authority to carry out works to (a) tree(s) on land situated at:

Location: St Marys University College, Waldegrave Road, Twickenham, Middlesex.

As described in the attached schedule

NOW THEREFORE WE THE MAYOR AND THE BURGESSES OF THE LONDON BOROUGH OF RICHMOND UPON THAMES acting by the Council of the said Borough, the Local Planning Authority, HEREBY GIVE YOU NOTICE pursuant to the said Act and Orders made thereunder that their decision on your application to carry out tree work(s) on the said land is as set out on the attached schedule.

Yours faithfully

Glen Harding
Acting Arboricultural Manager
Environment Directorate

APPLICANT NAME**AGENT NAME**

Catherine Birch
Ingleton Wood
434 The London Fruit And Wool Exchange
Brushfield Street
London
E1 6EX

SITE:

St Marys University College, Waldegrave Road, Twickenham, Middlesex.

PROPOSAL:

T1 - Yew (*Taxus baccata*) - Remove.

T2 - Sycamore (*Acer pseudoplatanus*) - Prune back.

T3 (T5 on plan) - Various - Prune back to improve vistas.

DETAILED CONDITIONS**U10410**

Your application for T2 and T3 (T5 on plan) was refused because the removal of these trees would be detrimental to public amenity and the amenity of the plaza.

U10411

Permission is however GRANTED for T2 and T3 (T5 on plan) to lift crown to 3 metres above ground level. Reduce small branches by 1 metre above bench to improve view of chapel.

T1 Works agreed to tree labelled T1

The works requested are agreed to the tree labelled T1 and as described in the proposal above.

TP03 BS3998 (1989)

The proposed work is to be carried out to British Standard 3998 (1989) by a reputable tree surgeon to the satisfaction of the Tree Preservation Officer who should be informed of the date of commencement of work.

DETAILED INFORMATIVES (when applicable)**P02Section 78 - Appeal**

The applicant's attention is drawn to Section 78 of the Town and Country Planning Act 1990, by which an appeal may be made to the Secretary of State within 28 days of notification of this decision.

ADDITIONAL STANDARD INFORMATIVES

1. If you alter the proposals in any way a further application(s) will be required. Accordingly you should contact the Tree Preservation Officer of Environment |Planning and Review Department, Civic centre, 44 York Street, Twickenham TW1 3BZ.
2. You are advised that if you are not the owner(s) of the tree(s) the subject of the approval(s) that the permission of the tree owner(s) will be required prior to the commencement of work(s). Accordingly if you are not the owner(s) you should discuss the application(s) with them forthwith.

**TREE OFFICER
REPORT**

Application reference: 06/T0297/TPO

Date application received	Date made valid	Target report date	6 TCA / 8 TPO Weeks
28.04.2006	28.04.2006		23.06.2006

Site: St Marys University College, Waldegrave Road, Twickenham, Middlesex

Proposal: T1 - Yew (Taxus baccata) - Remove.

T2 - Sycamore (Acer pseudoplatanus) - Prune back. *See attached*

T3 (T5 on plan) - Various - Prune back to improve vistas. *See attached*

APPROVE <i>T2, T3 (Kawanda)</i>	TPO TO BE SERVED	TP03 <input checked="" type="checkbox"/>	TP17 <input type="checkbox"/>	P02 <input checked="" type="checkbox"/>
REFUSE <i>T1</i>	NO TPO REQUIRED	TP04 <input type="checkbox"/>	TP23 <input type="checkbox"/>	P04 <input type="checkbox"/>
COURT ACTION		TP12 <input type="checkbox"/>		P06 <input type="checkbox"/>

TP01 - Reason for refusal
Your application was refused

Removal of this tree would be detrimental to public amenity and the amenity of the piazza.

TP02 - Change of work specification following refusal
Permission is however GRANTED

Left crown to 3m above ground level. Reduce two small branches by 1m above bench to improve view of chapel.

TP05 - Replacement Tree
The replacement tree is to be a, of a minimum size of and is to be planted The applicant is required to notify and obtain the agreement of the Local Planning Authority of the species and location of the replacement tree before planting.

Professional Comments:

See attached

Case Officer (Initials) *JA*
Dated: *27.6.06*

Development Control Manager *TD - [Signature]*
Dated: *26.6.06*

File Note

Application Reference: 06/T0297/TPO

Application Date: 28.4.06

St Mary's University College TPO 497 1996

Yew tree T1

Application to Remove this Yew

The tree is included in the TPO; it is a healthy tree in reasonable condition.

It was suggested to the applicant that crown lifting and minor pruning of two small branches would improve the view of the Chapel from the refurbished piazza without requiring the removal of the tree. This was accepted, the Estate Manager even preferred to retain the tree as there is a desire to light it as a Christmas tree.

Recommendation:

- i. Refuse consent to Remove.
- ii. Consent to crown lift to 3m over the Piazza and trim two small branches over the new bench by up to 1m.

Sycamore T2

This tree is in reasonable health and condition although sparse foliage was noted. This could be due to de-icing salt or poor drainage and rooting.

The application was to "Prune back" at the site meeting this was discussed to establish a description of the pruning proposed.

The proposal is to Lift the crown to 4m above ground level, clear the new lamp column by approximately 1m and remove deadwood (minor deadwood was evident).

I recommend that consent for this work is granted.

T3 (T5 on Plan) various species included in Group 2 within the Tree Preservation Order.

This TPO of this group includes the following trees: two Yew trees; two Maple trees; two Cherry trees; two Holly trees; one Hawthorn; one Alder and five Weeping birch.

The works to this group is for two objectives:

- i. Improve sight lines on the South Eastern corner of this group so that drivers have a better view around the corner.
- ii. Improve views between the Chapel-in-the-woods and the main Chapel.

After a discussion on site the following specification was agreed:

Works to trees/shrubs not included in TPO.

Remove Elder and young self set Norway Maple in Southeast corner of this group.
Remove shrubs including Eleagnus, Cypress shrubs, Mexican Orange Blossom etc.

Works to trees included in TPO (within South east part of group)

Irish Yew – No works

Two Holly trees – Lift crown to 2m above ground level.

Two Birch trees – Lift crown to 2m above ground level.

Common Yew adjacent Chapel - prune lateral branches to clear Chapel-in-the-woods by up to 1m.

Italian Alder adjacent Chapel-in-the-woods – Crown lift over pathways to 2.5m above ground level.

I recommend that consent is granted for the above works to TPO'd trees in this group.

Peter Holloway 27.6.06



LONDON BOROUGH OF
RICHMOND UPON THAMES

Environment Planning & Review

Tree Work Application

for works to trees which are the subject of a tree preservation order
or situated within a conservation area

Town & Country Planning Act 1990

Part 1: APPLICANT'S DETAILS

Name ST MARY'S COLLEGE

Address WALDEGRAVE ROAD
STRAWBERRY HILL, TWICKENHAM TW1 4SX

Daytime telephone number 0208 240 4096

Name of agent (CATHERINE BIRCH)
(if applicable) INGLETON WOOD

Address 434 THE LONDON FRUIT & WOOL EXCHANGE
BRUSHFIELD ST, LONDON, E1 6EX

Telephone number 020 7 377 0301

Part 2: THE TREE/S AND THE APPLICANT'S INTEREST IN THEM

Please give the address of the land on which the tree/s stand if different from the
applicant's address above.

Please note that if the trees are on an adjacent property, the address of this should be given.

ST MARY'S COLLEGE : CHAPEL COURTYARD - ADDRESS ABOVE

Is the applicant the owner of the land? YES/NO

If the answer to the above is NO, you are reminded that in most cases the consent of the tree owner/s will be required
before works may commence.

If the applicant is not the owner, please provide details of the owner of the land upon
which the trees grow: NA.

Name

Telephone number

Is the tree/s the subject of a tree preservation order (TPO)? YES/NO

If so, please give the TPO number/s if known.

NOT KNOWN.

continues >>

Part 2: THE APPLICATION

Please provide details of proposed works by completing the columns below. Continue on a separate sheet if necessary.

Ref no.	Species	Operations proposed	Reasons
TPO 1	NOT KNOWN :- <i>Taxus</i> CONIFER (see photograph).	Removal	OBSCURES VIEWS, CASTS SHADOWS, ENCLOSED COURTYARD
TPO 2	NOT KNOWN :- DECIDUOUS <i>Syringa</i> (see photograph)	PRUNE BACK	LARGE & OUT OF SCALE WITH COURTYARD, CASTS SHADOWS.
3	VARIOUS SHRUBS & CONIFERS IN CONCRETE PLANTERS	PRUNE BACK & REMOVE SOME CONIFERS. RE PLANT WITH SMALLER SPECIES	PLANTING NOW LARGE & OUT OF SCALE WITH COURTYARD
4		REMOVE & RE- PLANT PLANTERS	
TPO 5	VARIOUS TREES & SHRUBS AROUND CHAPEL 'IN THE WOODS'	PRUNE BACK TO IMPROVE VISTAS.	IMPROVE & OPEN UP VISTAS.

REFER
TO
ATTACH-
ED
PHOTO-
GRAPHS

In the box below, please provide a sketch or street plan (or attach a marked OS extract) showing the location of the trees in relation to surrounding property, and indicating for each tree the number from the list above.

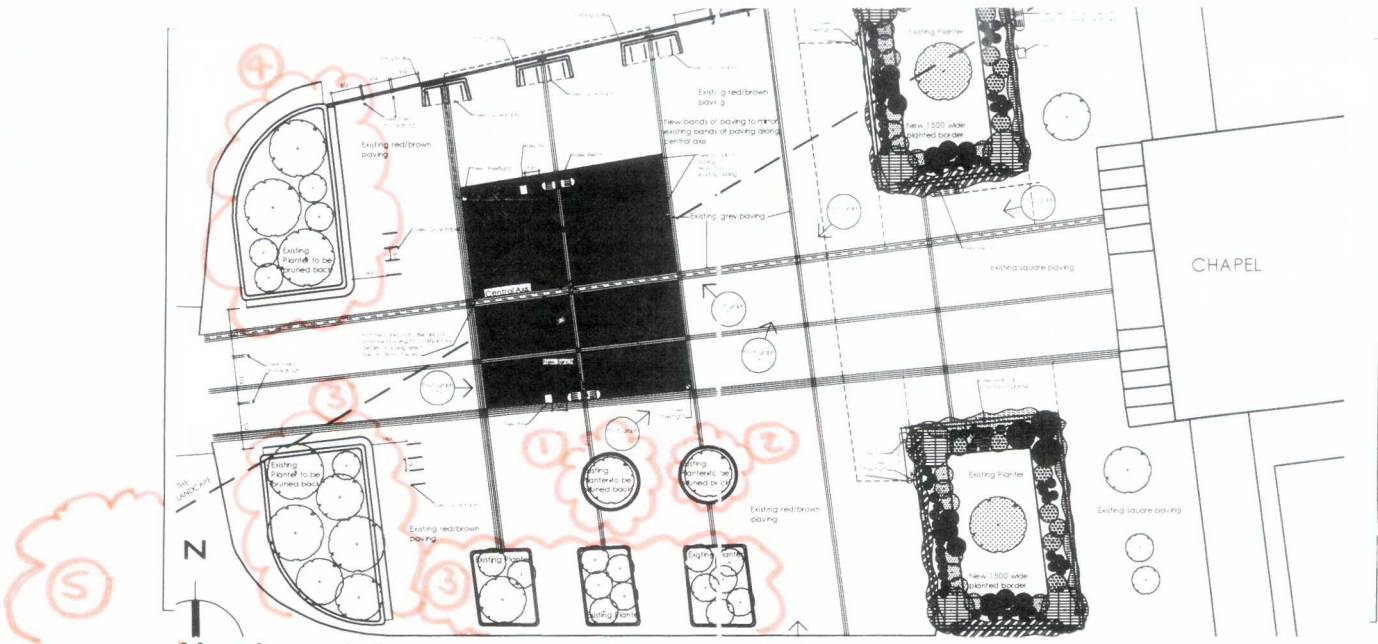

I hereby apply for the consent of the Council of the London Borough of Richmond upon Thames to carry out the work described above.

Signed: *CB*

Date: 27.04.06

Please send your completed application form to: Environment Planning & Review, Arboriculture Section, Civic Centre Room 213, 44 York Street, Twickenham TW1 3BZ. If you have any queries, please contact the Tree Preservation Officer at the above address, or telephone 020 8891 7808.

81066/CB/lb

27 April 2006

Environment Planning and Review
Arboriculture Section
Civic Centre Room 213
44 York Street
Twickenham
TW1 3BZ

Dear Sir/Madam

Re: St Mary's College – Tree Work Application

Please find enclosed our Tree Work Application on behalf of St Mary's College, Twickenham.

Please contact me if you have any queries.

Yours faithfully



Catherine Birch
Senior Interior Designer
catherine.birch@ingletonwood.co.uk

Enc.

a multi-disciplinary
practice of
architects
building
surveyors
building
services
consultants
quantity
surveyors
planning
supervisors
access
consultants

28 APR 2006

Environment Planning and Review
Arboriculture Section
Civic Centre Room 213
44 York Street
Twickenham
TW1 3BZ



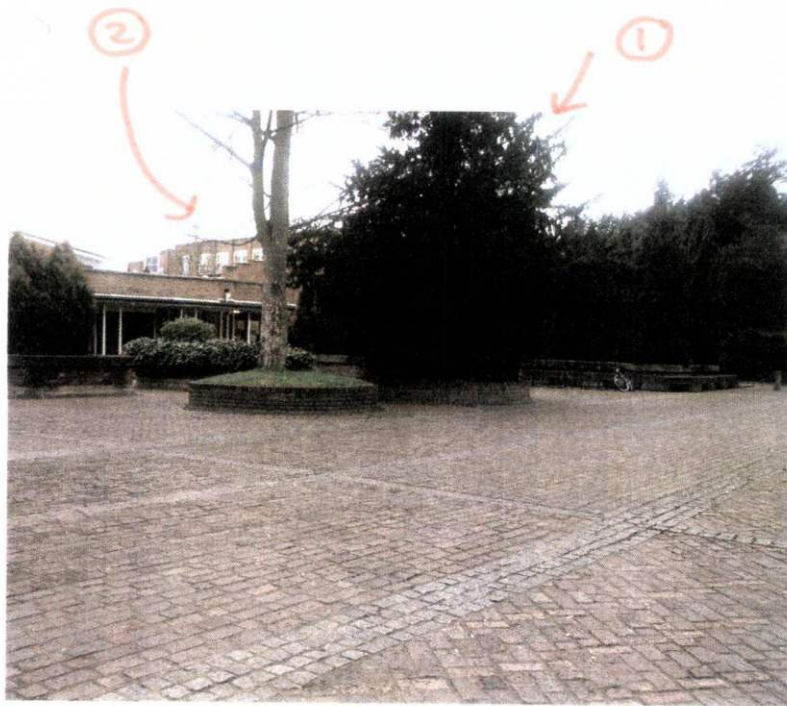



T1

T2



T3



T3



T3



T1

T2
↓



T3



T2

T3



T2

T1

T3





TS







R LONDON BOROUGH OF
RICHMOND UPON THAMES
Environment Directorate

Ordnance Survey Map Extract

Reproduced from Ordnance Survey material with permission of Ordnance Survey on behalf of the Controller of Her Majesty's Stationary Office. (c) Crown Copyright. Unauthorised reproduction infringes Crown Copyright and may lead to prosecution or civil proceedings. London Borough of Richmond Upon Thames LA 100019441 2006 For reference purposes only. No further copies may be made.

CIVIC CENTRE, 44 YORK STREET
TWICKENHAM, TW1 3BZ.
TEL: 020 8891 1411, TEXTPHONE: 020 8891 7120.
www.richmond.gov.uk

Co-ordinates at centre of map:
Easting: 515756 Northing: 172141

Scale 1: 500	Date 27/06/06	Section TRE	Drawn PH
-----------------	------------------	----------------	-------------



Produced using Datamap, the directorate's Geographic Information System (GIS).



R LONDON BOROUGH OF
RICHMOND UPON THAMES
Environment Directorate

Ordnance Survey
Map Extract

Reproduced from Ordnance Survey material with permission of Ordnance Survey on behalf of the Controller of Her Majesty's Stationary Office.
(c) Crown Copyright
Unauthorised reproduction infringes Crown Copyright and may lead to prosecution or civil proceedings.
London Borough of Richmond Upon Thames
LA 100019441 2006
For reference purposes only.
No further copies may be made.

CIVIC CENTRE, 44 YORK STREET
TWICKENHAM, TW1 3BZ.
TEL: 020 8891 1411, TEXTPHONE: 020 8891 7120.
www.richmond.gov.uk

Co-ordinates at centre of map:
Easting: 515734 Northing: 172138

Scale 1: 200	Date 27/06/06	Section TRE	Drawn PH
-----------------	------------------	----------------	-------------



Produced using Datamap, the directorate's Geographic Information System (GIS).

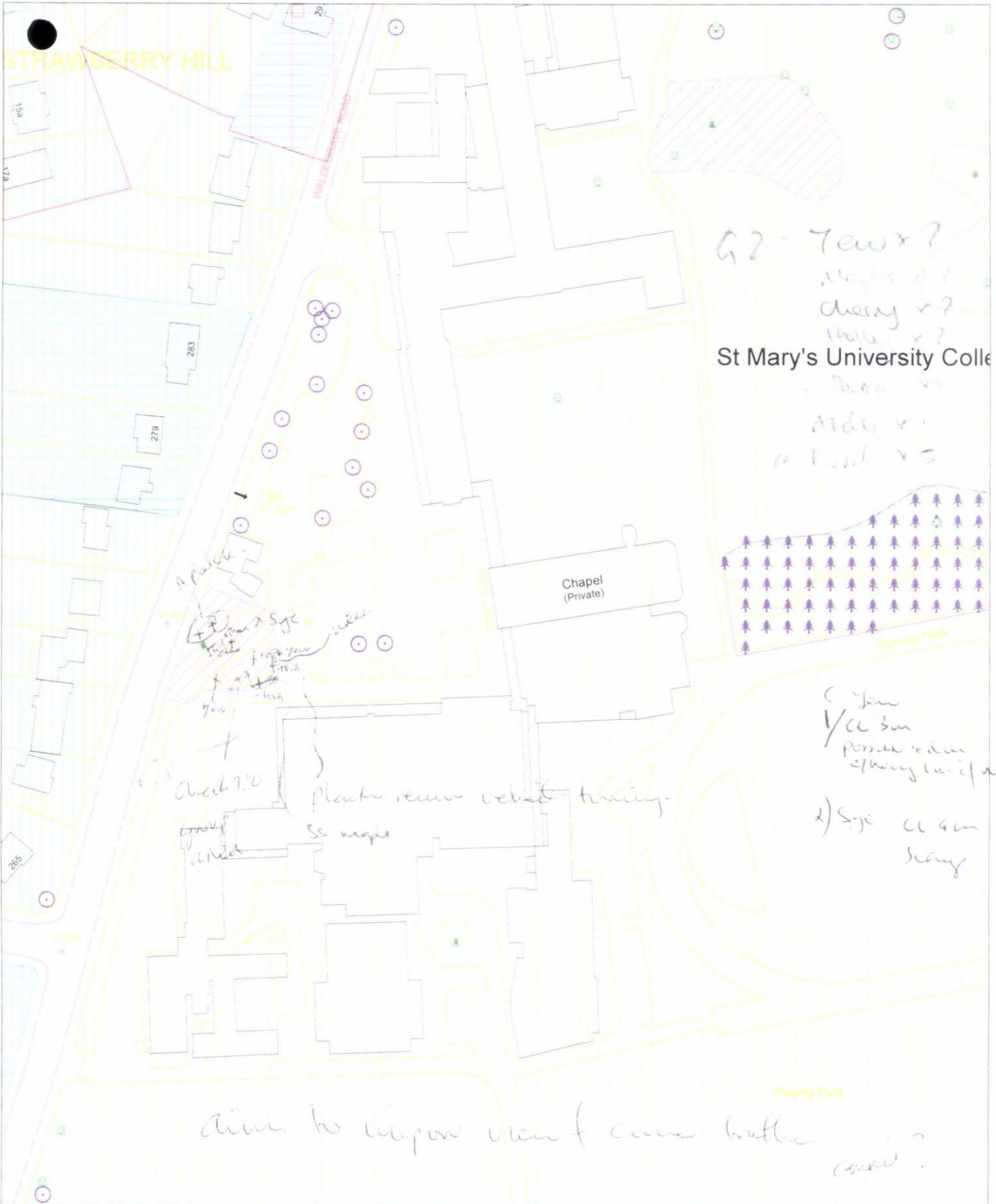

R LONDON BOROUGH OF
RICHMOND UPON THAMES
Environment Directorate

**Ordnance Survey
Map Extract**

Reproduced from Ordnance Survey material with permission of Ordnance Survey on behalf of the Controller of Her Majesty's Stationary Office. (c) Crown Copyright. Unauthorised reproduction infringes Crown Copyright and may lead to prosecution or civil proceedings. London Borough of Richmond Upon Thames LA 100019441 2006 For reference purposes only. No further copies may be made.

CIVIC CENTRE, 44 YORK STREET
TWICKENHAM, TW1 3BZ.
TEL: 020 8891 1411, TEXTPHONE: 020 8891 7120.
www.richmond.gov.uk

Co-ordinates at centre of map:
Easting: 515799 Northing: 172147

Scale	Date	Section	Drawn
1: 1250	24/05/06	TRE	CR



Produced using Datamap, the directorate's Geographic Information System (GIS).