

NOTES:
 DO NOT SCALE FROM THIS DRAWING. ALL DIMENSIONS TO BE CHECKED ON SITE. ALL OMISSIONS AND DISCREPANCIES TO BE REPORTED TO THE ARCHITECT IMMEDIATELY.
 ALL RIGHTS RESERVED. THIS WORK IS COPYRIGHT AND CANNOT BE REPRODUCED OR COPIED OR MODIFIED IN ANY FORM OR BY ANY MEANS, GRAPHIC ELECTRONIC OR MECHANICAL, INCLUDING PHOTOCOPIING WITHOUT THE WRITTEN PERMISSION OF SQUIRE AND PARTNERS ARCHITECTS.

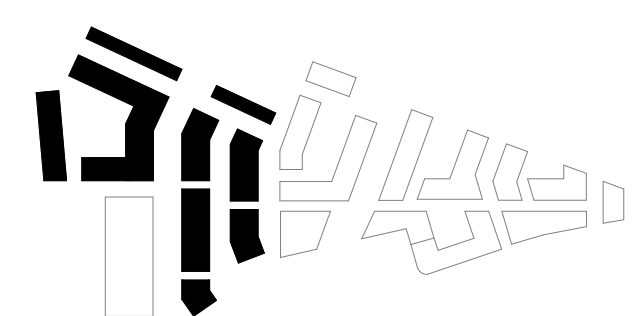

--- BLOCK ABOVE FOOTPRINT
 --- PLANNING APPLICATION BOUNDARY
 +2.45m MAXIMUM BASEMENT DEPTH

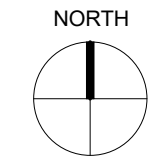
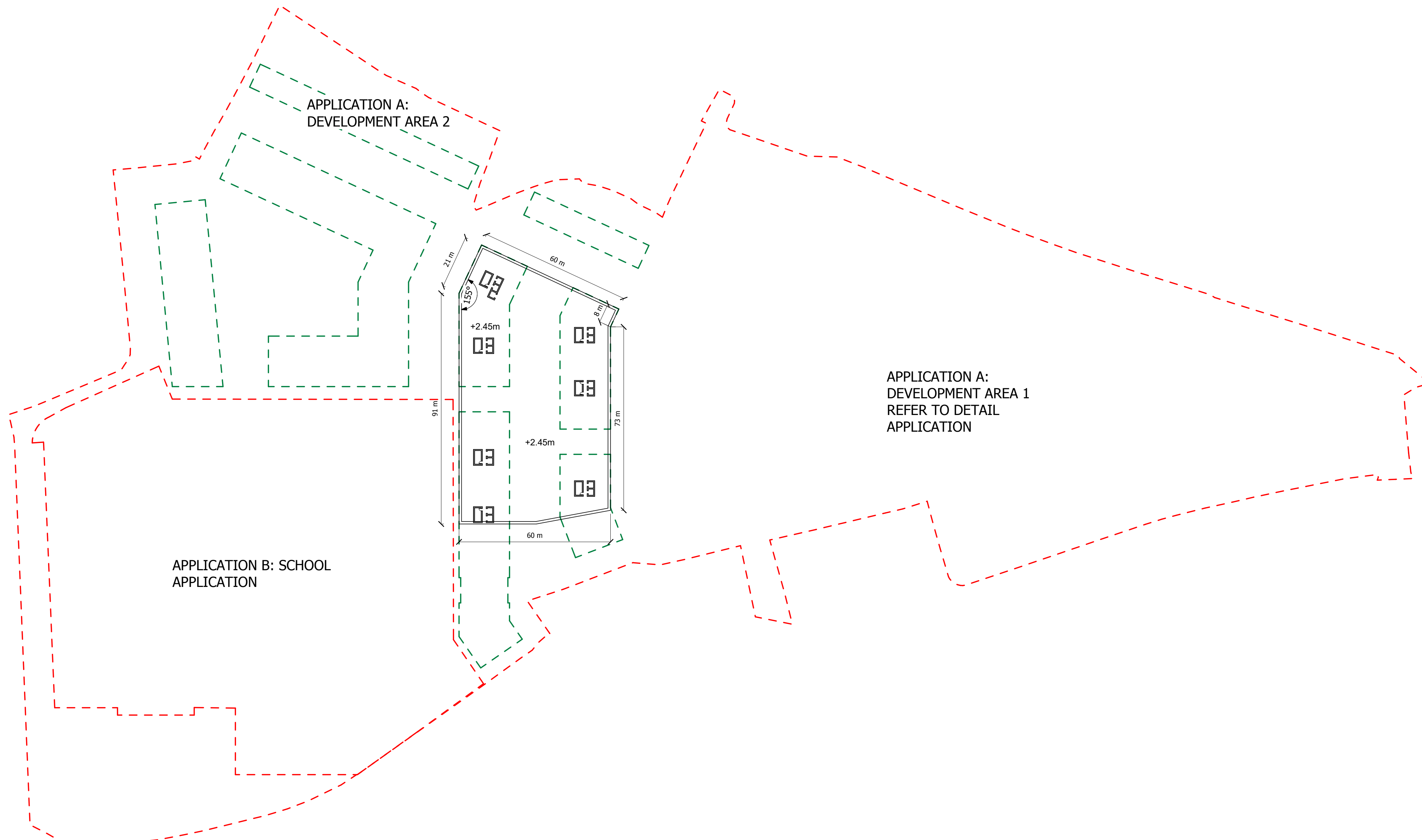

LBRUT 2 APPLICATION	25/02/22	BJ	E
FINAL DRAFT HYBRID SUBMISSION	12/01/22	RKB	D
GLA SUBMISSION	27/04/20	BJ	C
DRAFT GLA SUBMISSION	24/01/20	KH	B
FINAL DRAFT PLANNING APPLICATION	21/10/19	KH	A
LEGAL REVIEW	13/09/19	KH	-

Revision description	Date	Check	Rev

SQUIRE & PARTNERS

The Department Store
 248 Ferndale Road London SW9 8FR
 T: 020 7278 5555 F: 020 7239 0495

info@squireandpartners.com
 www.squireandpartners.com

Project
Stag Brewery
 Richmond

PROPOSED BASEMENT MAXIMUM DEPTH AND EXTENT

Drawn	Date	Scale
KHO	13/09/19	1 : 1000 @ A1 1 : 2000 @ A3
Job Number	Drawing number	Revision
18125	C645_Z2_P_PR_010	E

